



TYGER®

FENDER FLARE

TG-FF8G4358

READ INSTRUCTIONS CAREFULLY BEFORE STARTING INSTALLATION. ONLY FOLLOW THE APPROVED INSTALLATION ACCORDING TO THESE WRITTEN INSTRUCTIONS. FAILURE TO DO SO MAY CAUSE DAMAGE TO YOUR VEHICLE AND INVALIDATE THE WARRANTY.

PRIOR TO INSTALLATION:

- Remove contents from box. Verify all parts are present and free from any defects or damage.
- Make sure installation is done on a non-abrasive surface to avoid scratching the flare surface.
- Verify the fit of each flare to the vehicle body to ensure you have the correct flares for your vehicle.
- Remove existing decals and mud flaps on the vehicle that may interfere with flare installation.
- Do not use any harsh abrasive detergent to clean the flare.

PAINTING: Painted flares cannot be returned. Test fit before painting. We are not responsible for any costs that may incur if flares were painted without test fitting.

- Clean surface to be painted with a good grade degreaser. Do not use lacquer thinner or any solvent based product.
- Wipe flare surface completely dry with a tack rag prior to paint.
- Application of plastic adhesion promoter for PP plastic as per your paint system manufacturer's recommendations is required.
- Use a high quality enamel or polyurethane automotive paint to paint the flares.
- Not recommend to paint the edge trim, but if desired use a flex additive.

WARNING

Dirt or debris may become lodged between flares and vehicle's fenders causing scratching and paint wear from vehicle vibration. TYGER is not responsible for any damage, and installation is done with buyer's understanding that this damage may potentially occur.

SAFETY INFORMATION

- Before driving, ensure that flare is properly secured to vehicle.
- Do not use automatic "brush-style" car wash.
- Periodically check all components for tightness.

Tools Required

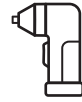

Right Angle Ratchet



3/32" Drill



#2 PH Driver



Socket Wrench



Grease Pencil



1/2" Socket



7mm Socket



10mm Socket



Floor Jack

Hardware Included



[A]



[B]



[C]



[D]



[E]



[F]



[G]

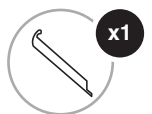

[H]

DAMAGED or MISSING PARTS?

www.TygerAuto.com/Contact



EDGE TRIM INSTALLATION

- Peel 2 inches of red backing away from one end of Edge Trim **[A]** .
- Apply Edge Trim over top edge of flare with adhesive side contacting inside edge of flare.
- Press Edge Trim into place and apply thumb pressure to ensure good adhesion, pull away red backing as you work your way around flare edge in one-foot increments. (Fig 1)

NOTE: Do not stretch Edge Trim during application.

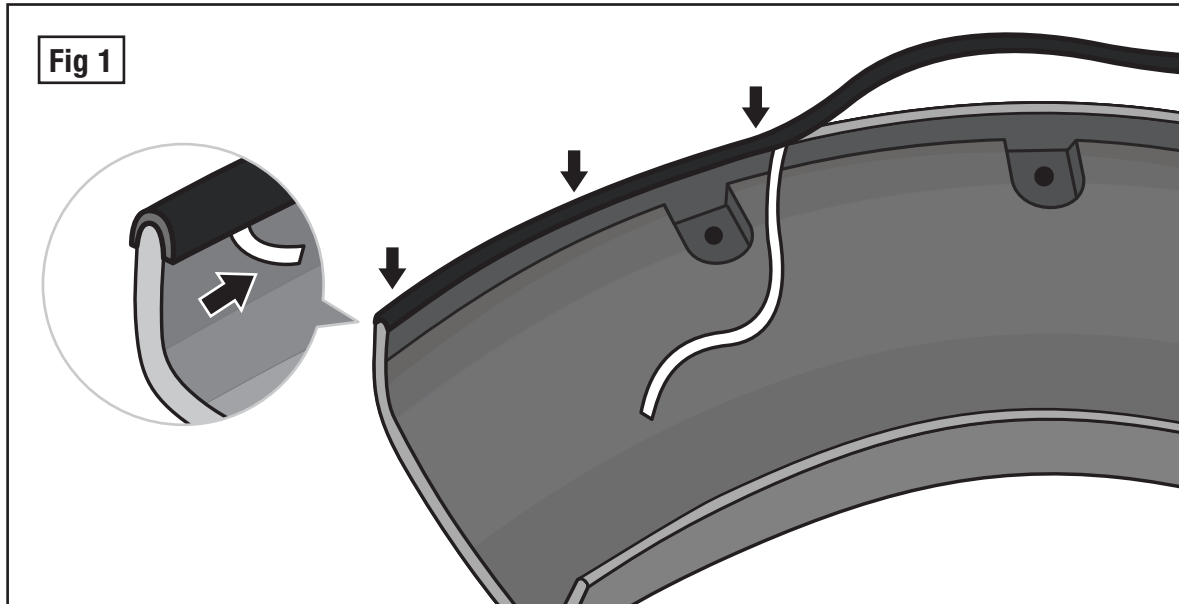

DECORATIVE RIVET INSTALLATION

- Install a Torx Bolt **[B]** with a Washer **[C]** through each of the top holes around the flare and secure using a Nylock Nut **[D]** on the other side. Tighten using a socket wrench and the supplied Torx Bit **[E]**. Do not overtighten as this may damage the flare. (Fig 2)

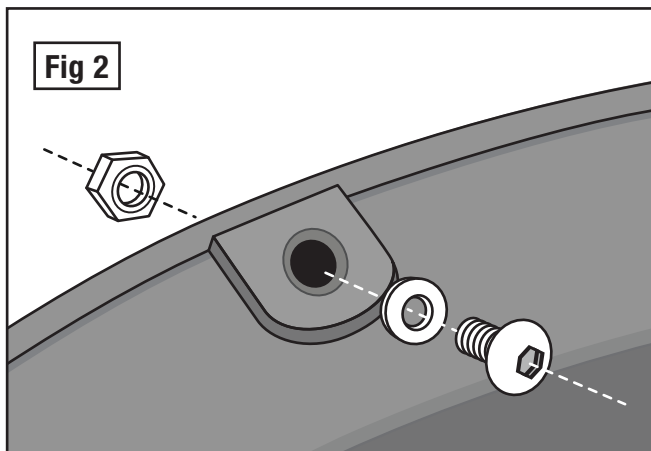

IMPORTANT: Do not drill holes to the vehicle body as rivets are decorative and fasten only to the flare. Do not attempt to use the bolts to fasten flare to vehicle body.

EXTRA NOTES

- All exposed fasteners and bare metal should be treated with rust resistant paint before installing flares. Spray inner fender wells with undercoating after flare installation.
- Modifications may be necessary to maintain a minimum 4" clearance between flares and exhaust pipes. (Exhaust gases should not vent directly onto flares)
- For vehicle with large tires may require lowering bump stops and/or installing steering stops to prevent tire from contacting flare.

Front Driver Side Installation

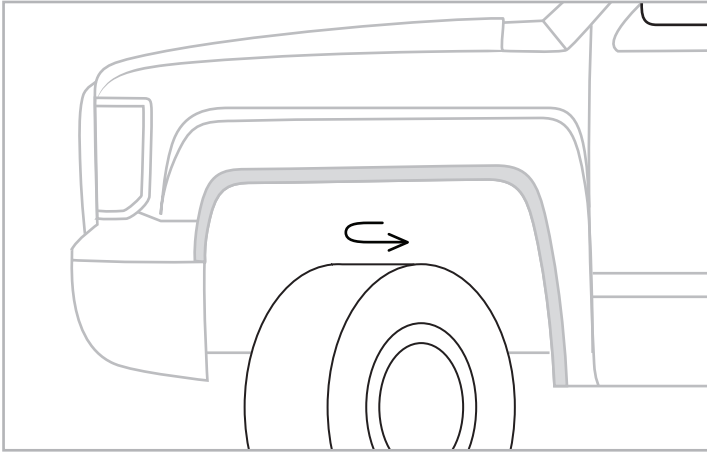

STEP 1: For easier installation, turn tire outward.

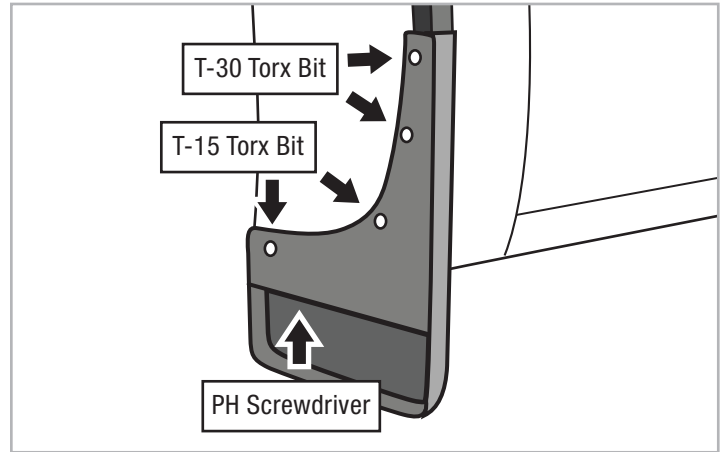

STEP 2: Remove factory mudguard if equipped. With the indicated tools, remove the corresponding factory screws and keep for later use.

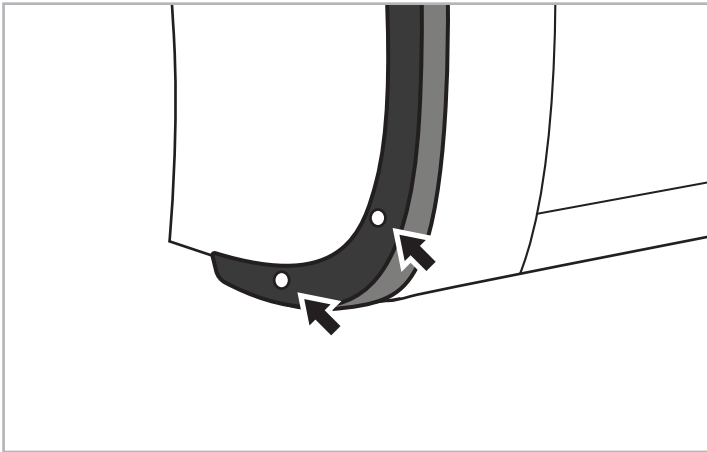

STEP 3: With a T-15 Torx Bit, remove 2 bottom rear factory screws.

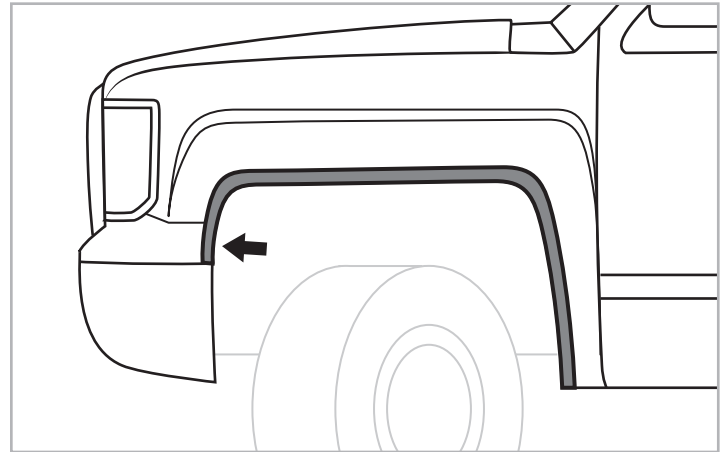

STEP 4: With a 9/32" socket wrench, remove the factory screw from the front and keep for later use.

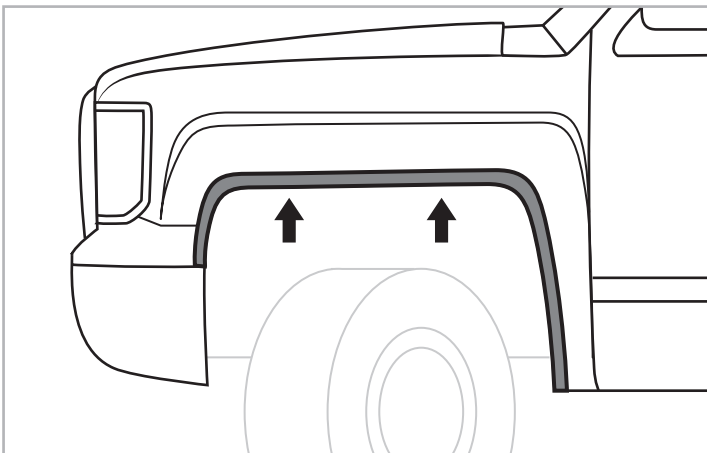

STEP 5: With a T-15 Torx Bit, remove 2 factory screws along the top.

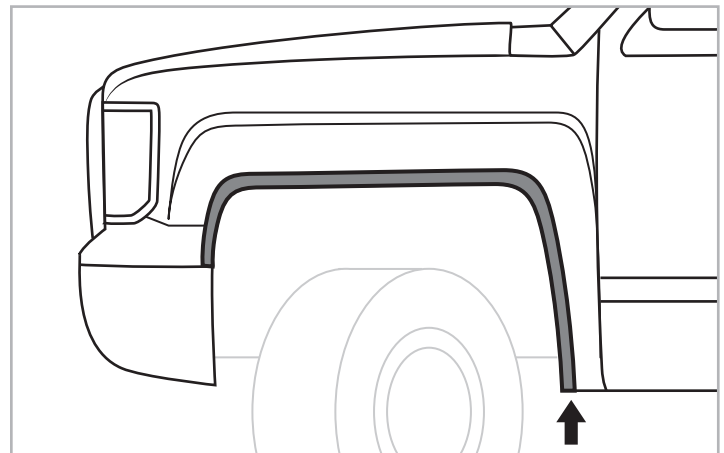

STEP 6: With a 1/2" socket wrench, remove factory fastener from underside of factory flare molding and keep for later use.

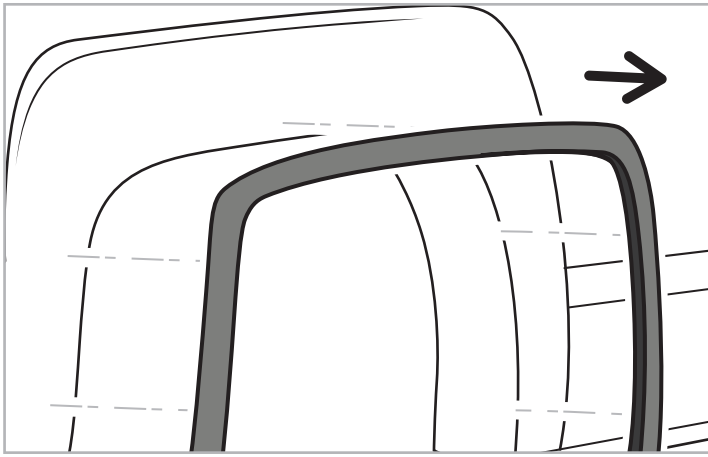

STEP 7: Remove factory flare by pulling away from the vehicle starting at the lower rear end. (Popping sounds are normal).

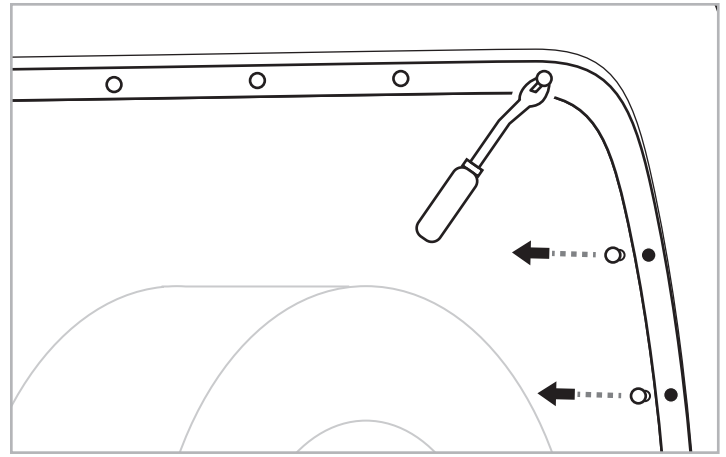

STEP 8: With a pry tool, remove any remaining factory fasteners.

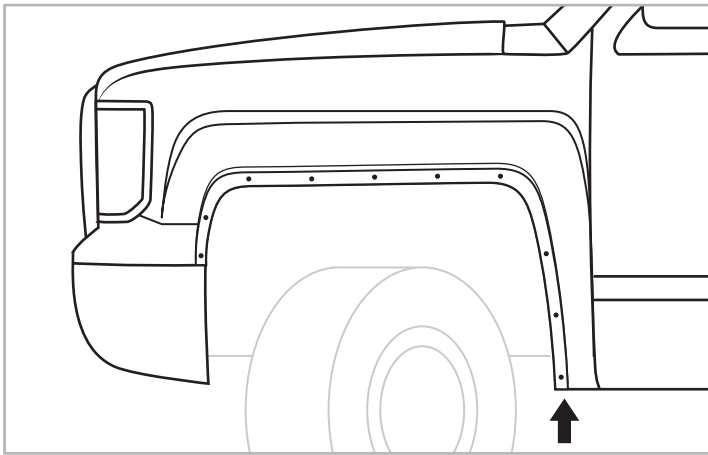

STEP 9: With a 1/2" socket wrench, reinstall factory screw removed in Step 6.

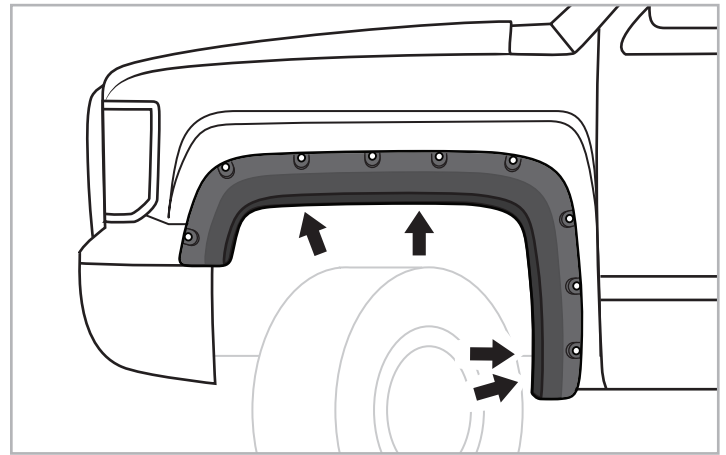

STEP 10: Hold flare in position, install 4 supplied PH Screws [F] through holes in flare and into vehicle's factory holes. Do not tighten.

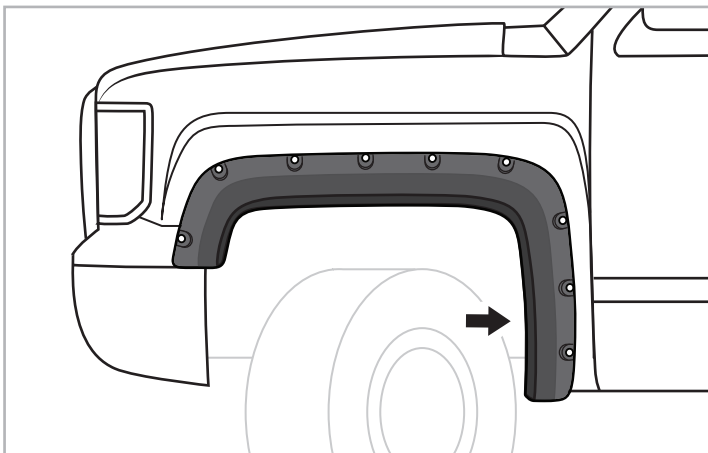

STEP 11: With a grease pencil, mark 1 location using hole in flare as guide.

NOTE: Not needed for vehicles which factory mudguard installed.

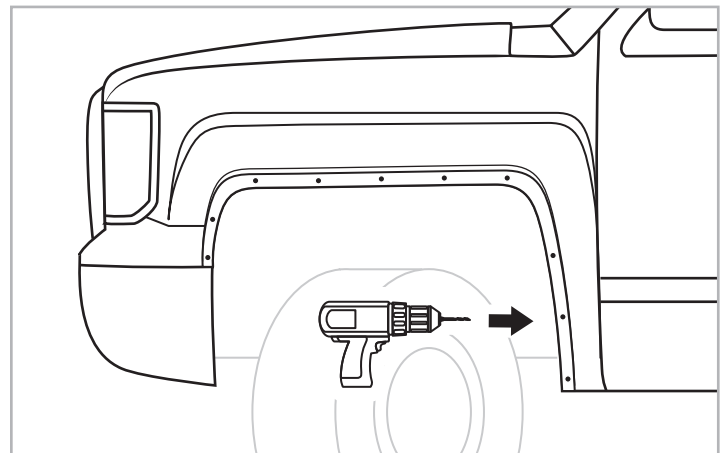

STEP 12: Uninstall screws from Step 10 and remove flare. With a 3/32" drill bit, drill a hole at the mark made in Step 11.

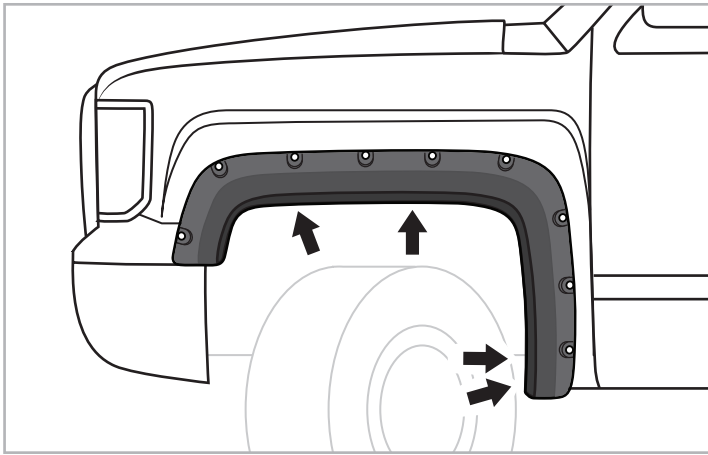

STEP 13: Reposition flare and reinstall 4 supplied PH Screws [F] through holes in flare and into vehicle's factory holes. Do not tighten.

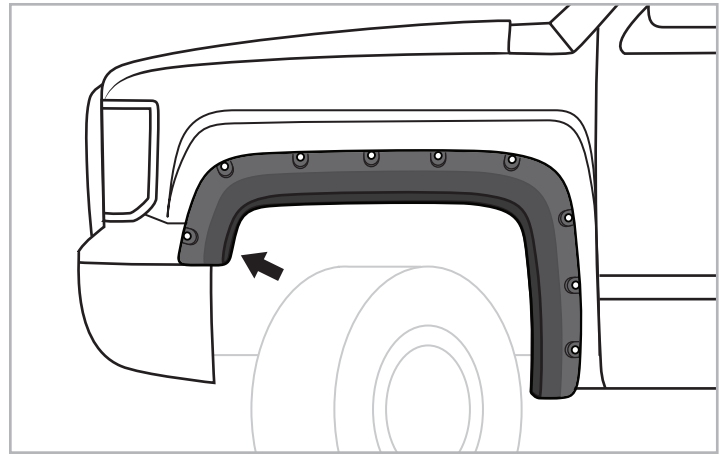

STEP 14: Firmly press and hold flare in position. With 9/32" socket wrench, reinstall factory screw removed in Step 4 through hole in flare and into vehicle's factory hole. Do not tighten.

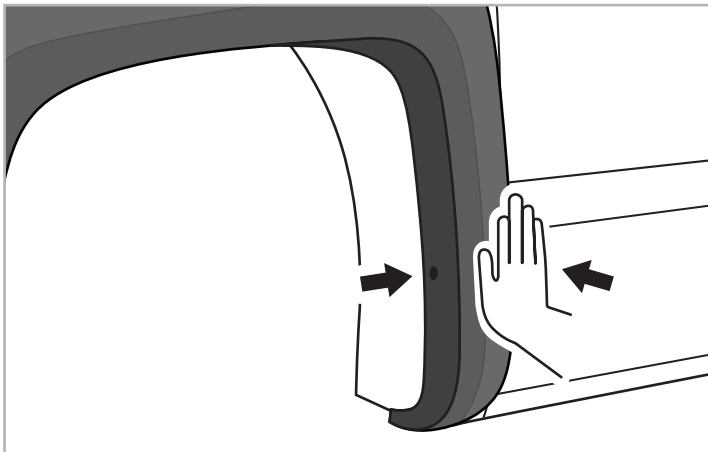

STEP 15: Install a supplied PH Drill Screw [G] into hole drilled in Step 12. Push flare firmly against the vehicle while tightening the screw.

NOTE: Not needed for vehicles which had factory mudguard installed.

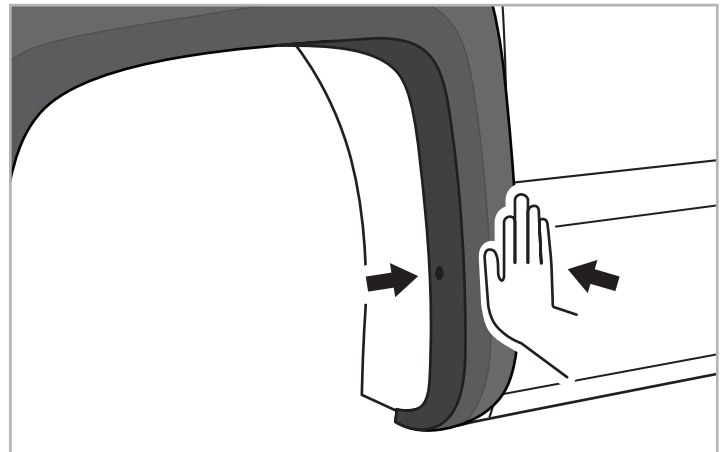

STEP 16: For vehicle with Factory Mudguard:
With a T-30 Torx Bit, reinstall a factory screws removed from Step 2. Push flare firmly against the vehicle while tightening the screw.

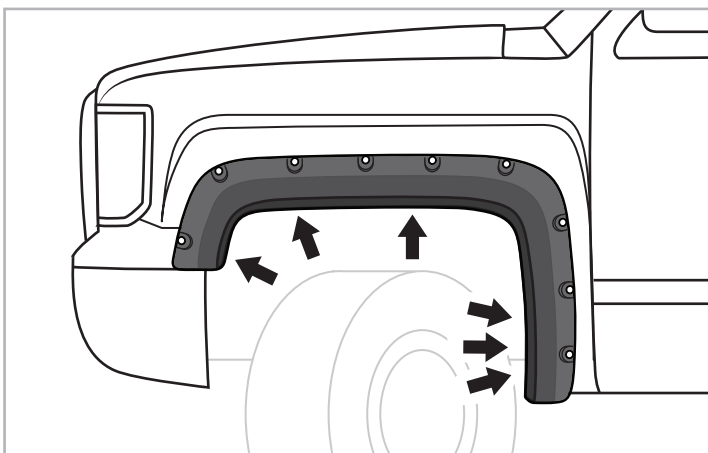

STEP 17: Push flare firmly against the vehicle while tightening all screws.

Rear Driver Side Installation

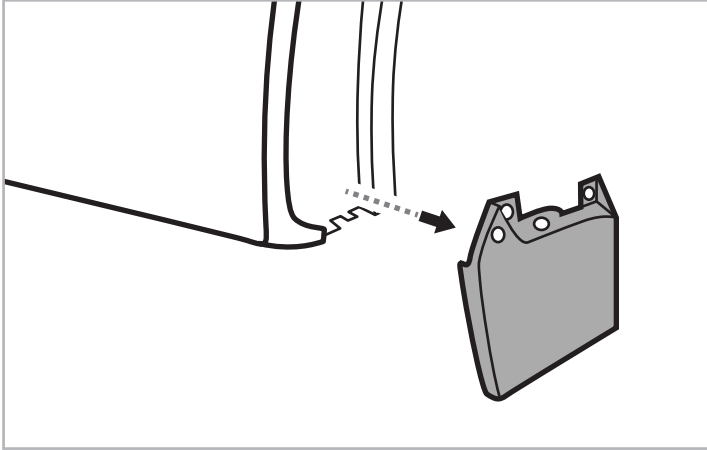

STEP 18: With a T-15 Torx Bit, remove 4 factory screws to remove factory mudguard.

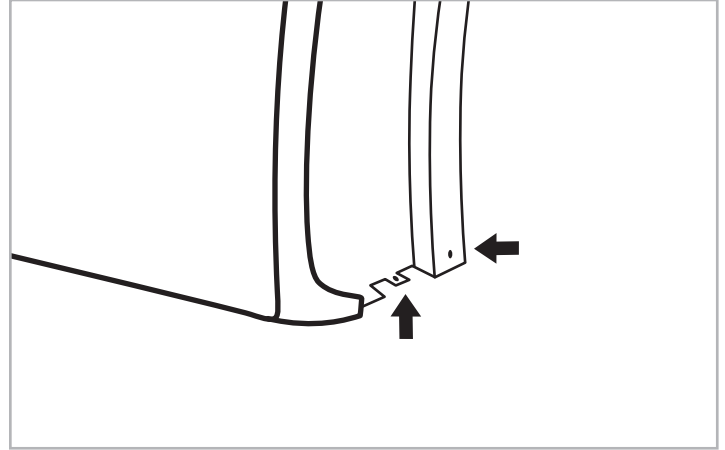

STEP 19: Reinstall 2 factory screws from Step 18 back into fender well liner.

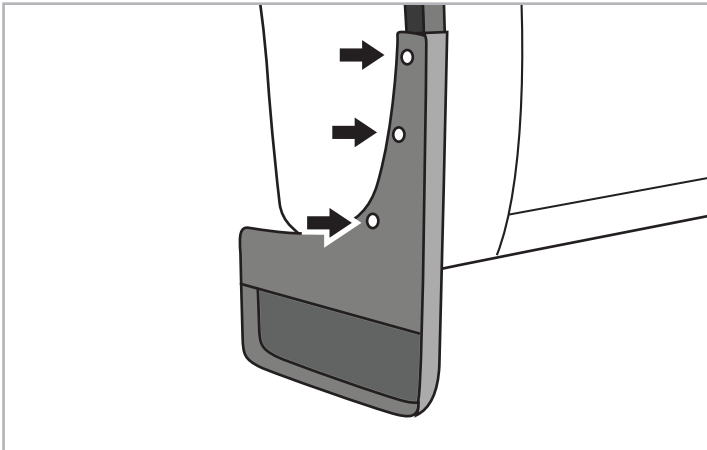

STEP 20: For vehicle with Factory Mudflap:
With a Phillips Screwdriver, remove 3 factory screws from the mudflap.

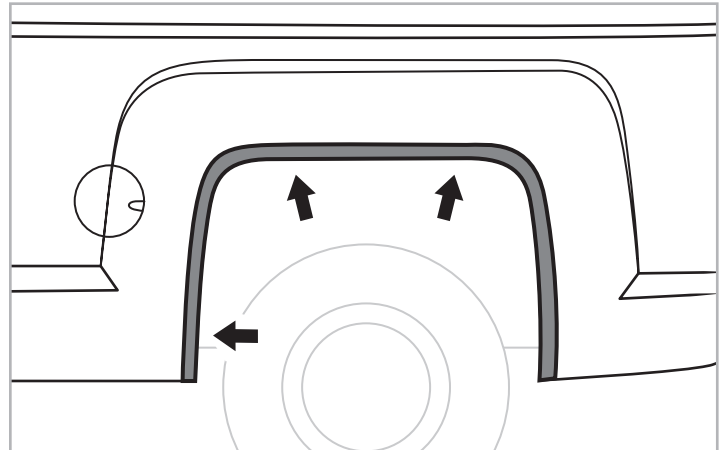

STEP 21: With a T-15 Torx Bit, remove 3 factory screws.

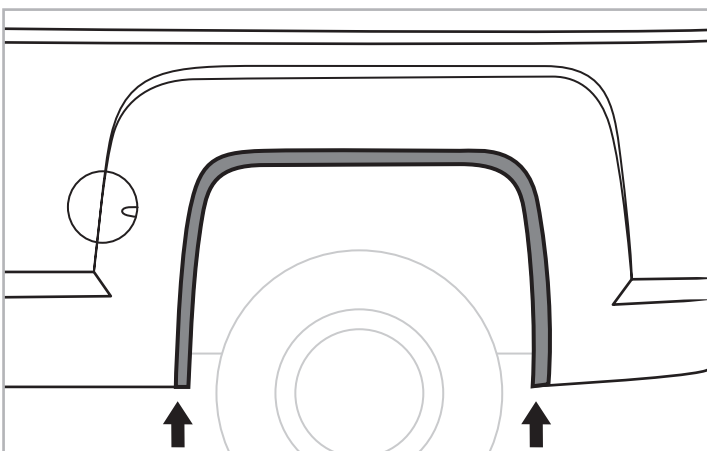

STEP 22: With a 10 mm socket wrench, remove 2 factory screws.

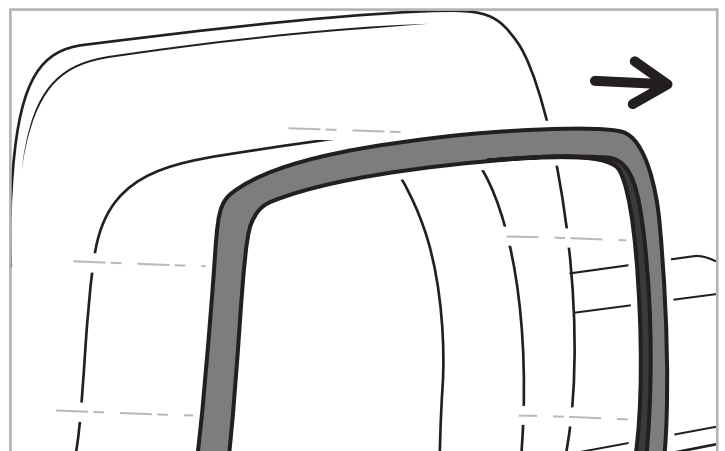

STEP 23: Remove factory flare by pulling away from the vehicle starting at the lower rear end. (Popping sounds are normal).

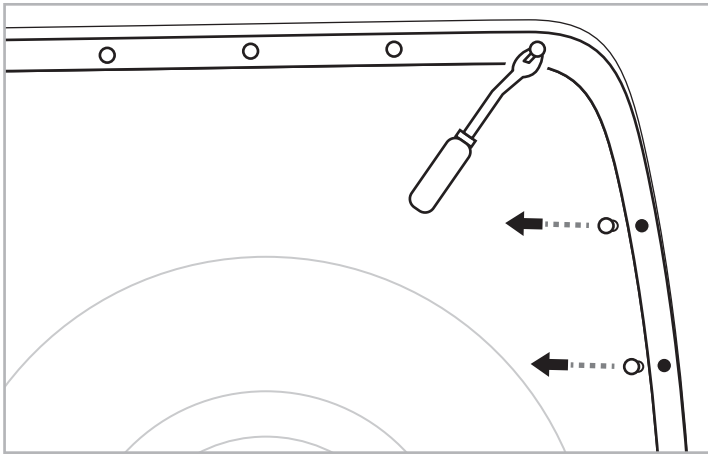

STEP 24: With a pry tool, remove any remaining factory fasteners.

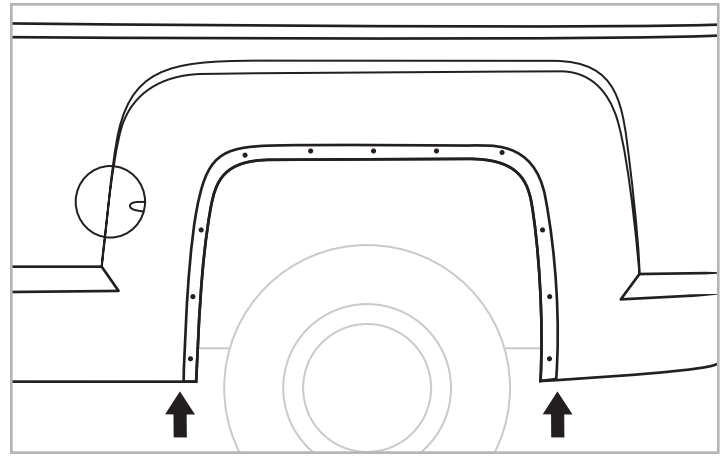

STEP 25: With a 10 mm socket wrench, reinstall 2 factory screws removed from Step 22.

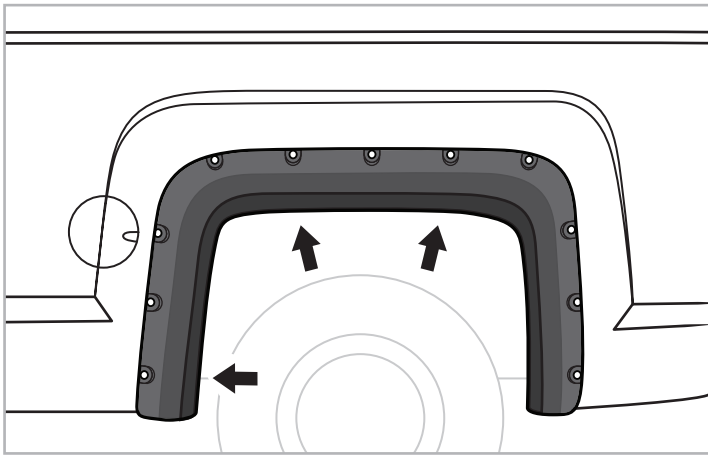

STEP 26: Hold flare in position, install 3 supplied PH Screws [F]. Do not tighten.

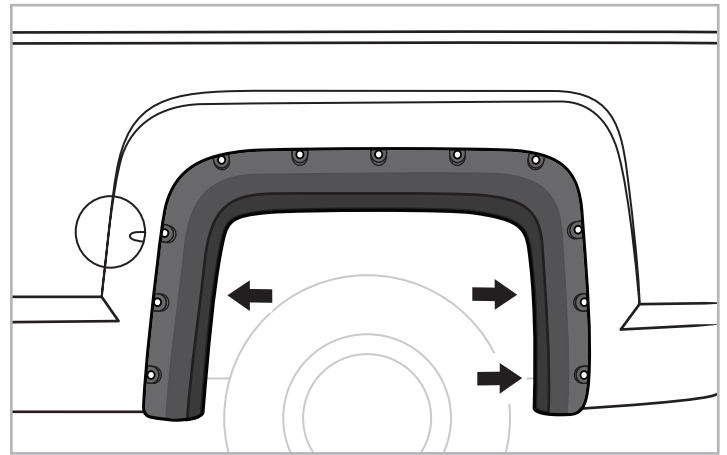

STEP 27: With a grease pencil, mark 3 locations using holes in flare as guide. Then, remove flare.

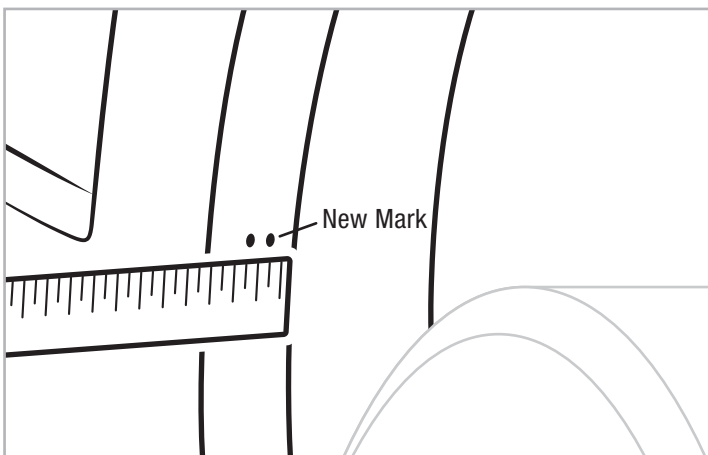

STEP 28: With a grease pencil, make a new mark for drilling that is 1/2" inward from the inside edge of the fender and horizontal to the mark from Step 27.

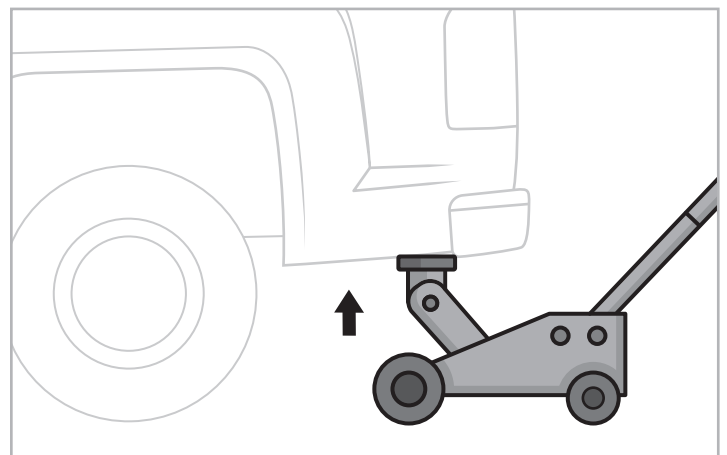

STEP 29: Rise rear truck bed with a floor jack or remove tire to allow access for drilling.

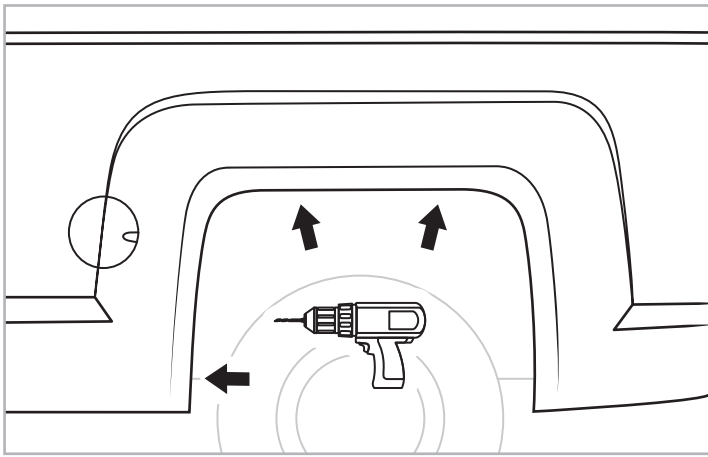

STEP 30: With a 3/32" drill bit, drill holes at the new marks made in Step 28.

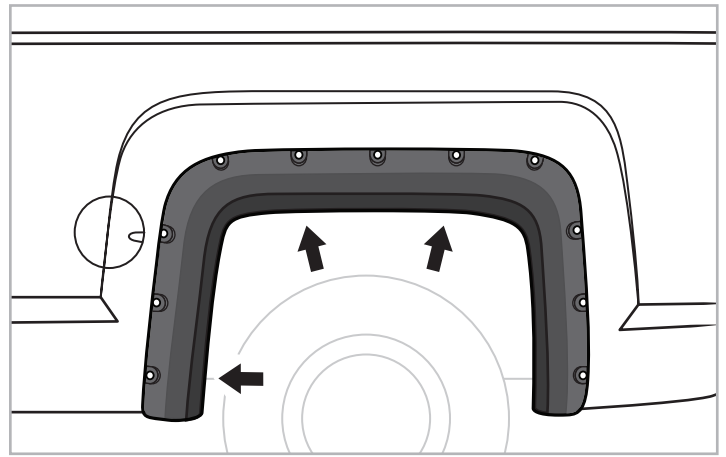

STEP 31: Reposition flare, reinstall 3 supplied PH Screws **[F]**. Do not tighten.

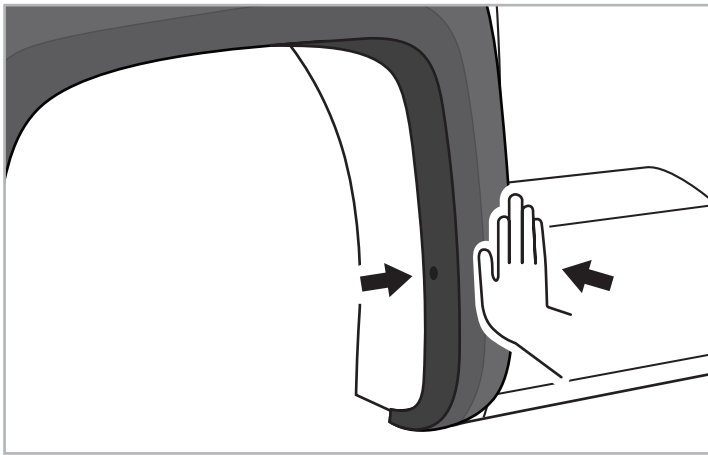

STEP 32: Install 3 supplied PH Drill Screws **[G]** at hole locations drilling Step 28. Push flare firmly against the vehicle while tightening the screws.

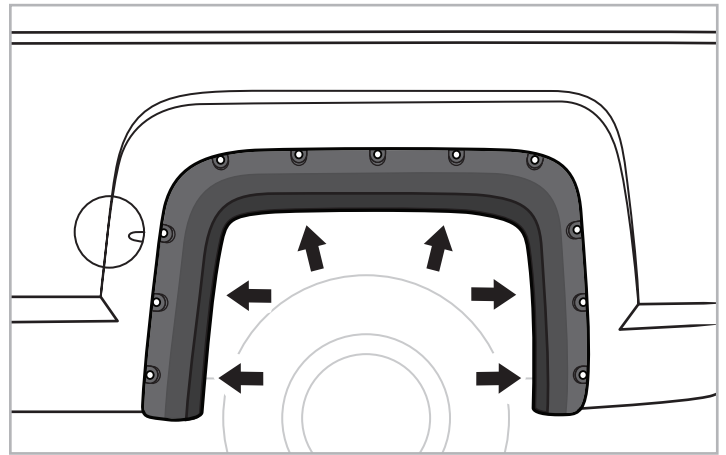

STEP 33: Push flare firmly against the vehicle while tightening all remaining screws.

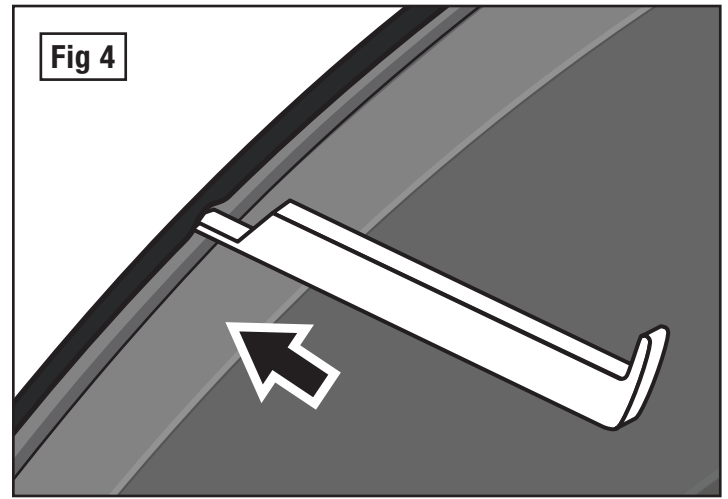
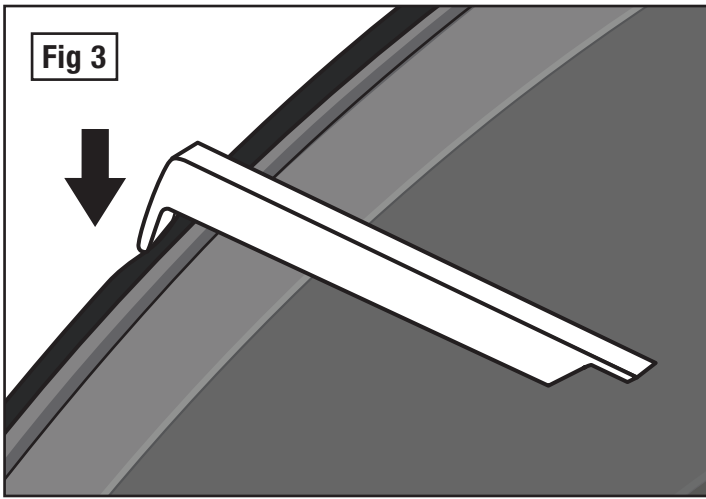

STEP 34: If needed use supplied tool **[H]** to trim outer edge (Fig 3) and inner edge (Fig 4) by inserting tool ends then sliding around the entire edge trims from one end to the other as shown in above pictures.

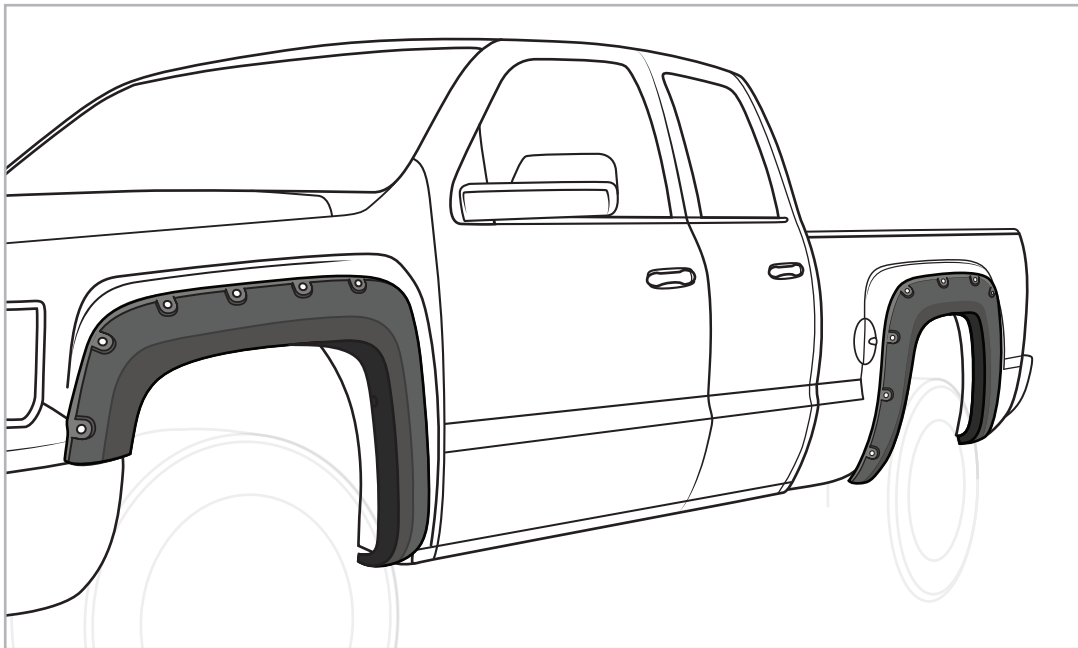

Driver side installation is completed. (Repeat the same steps on passenger side installation.)

FITMENT OR GAP ISSUE?

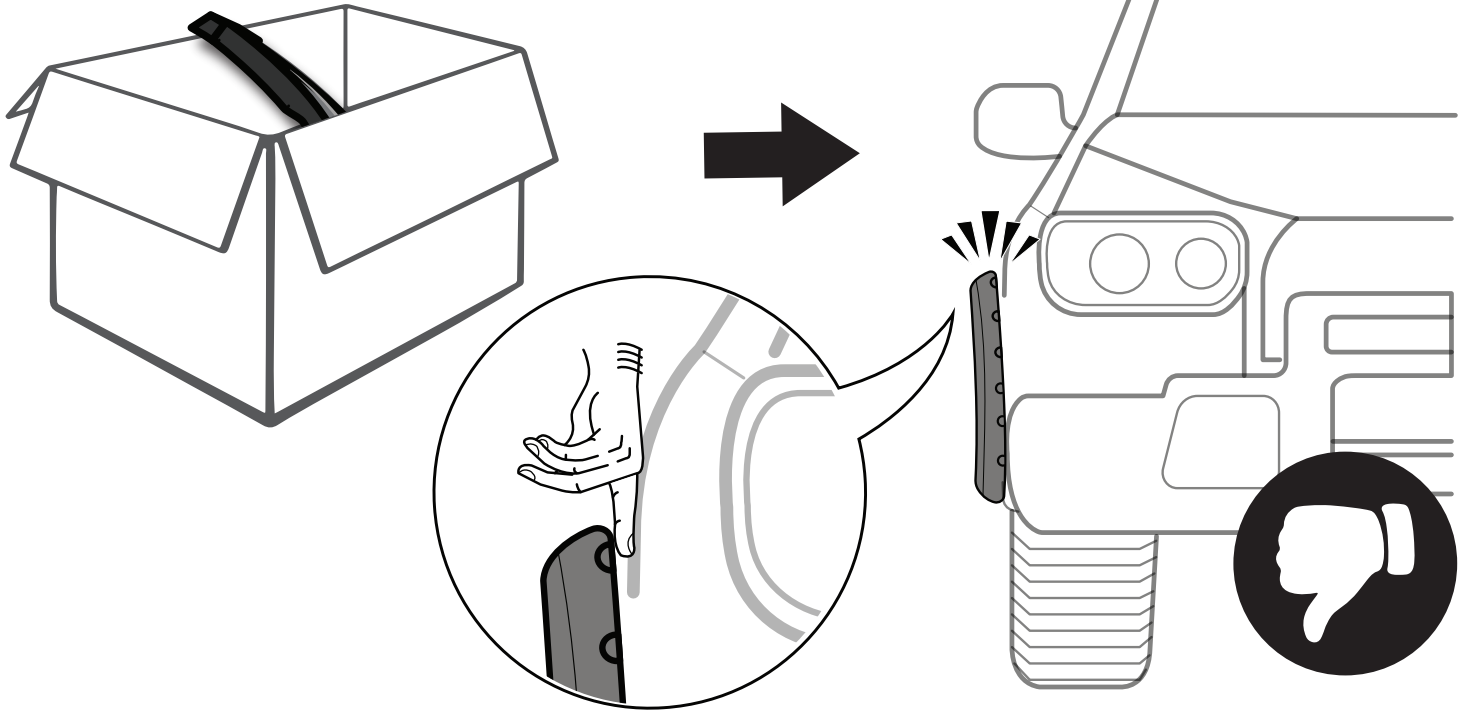

SOLUTION!

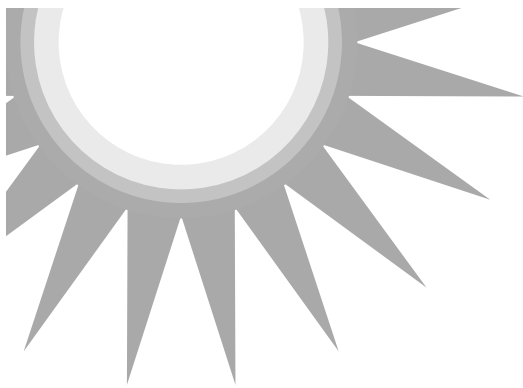

AFTER
2-3
HOURS

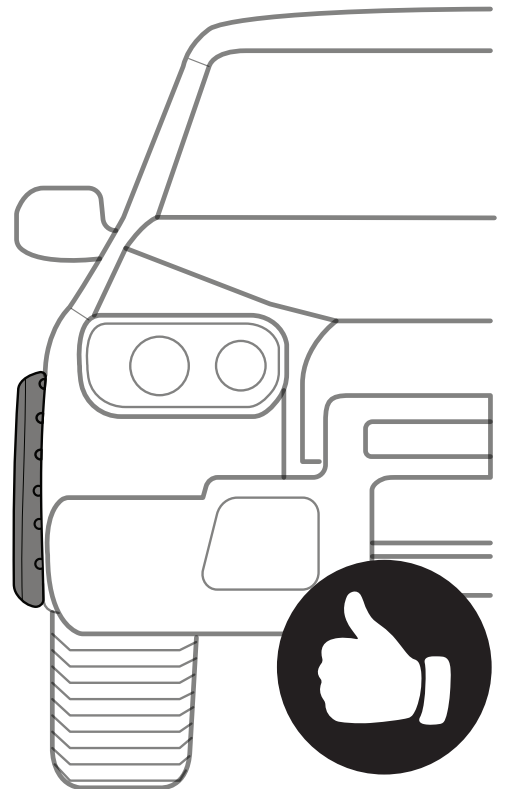
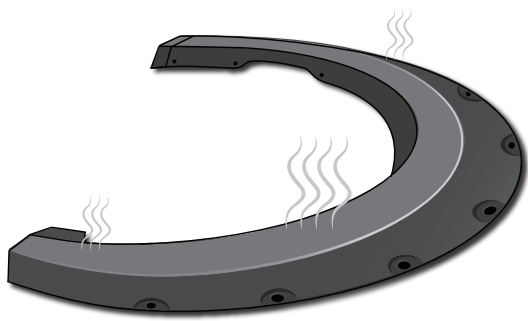

*In winter, heat gun or hair dryer may be used instead.