



TYGER®

TYGER GUARD™

BEFORE INSTALLATION

READ INSTRUCTIONS CAREFULLY BEFORE STARTING INSTALLATION. REMOVE CONTENTS FROM BOX AND VERIFY ALL PARTS ARE PRESENT. FAILURE TO IDENTIFY DAMAGE BEFORE INSTALLATION COULD LEAD TO A REJECTION OF ANY CLAIM. IF MISSING PARTS OR ANY DAMAGE FOUND, PLEASE TAKE A PICTURE FOR THE CLAIM PURPOSE. TO FILE YOUR CLAIM, PLEASE VISIT: WWW.TYGERAUTO.COM/CONTACT

TORQUE VALUES

Fastener Size	Class 8.8 Torque (ft-lbs)	Class 10.9 Torque (ft-lbs)
6mm	6-7	6-7
8mm	15-16	22-23
10mm	31-32	44-45
12mm	54-55	78-79
14mm	87-88	125-126

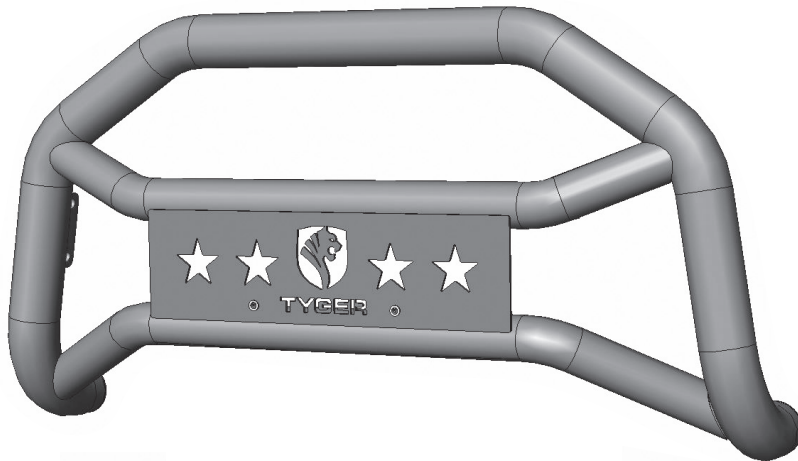

Passenger/Left Side
Mounting Bracket

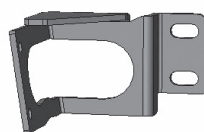

Driver/Right Side
Mounting Bracket

TG-GD6F60258

NOTE: Assistance is recommended.

Parts List

- x1 Tyger Guard
- x1 Driver/Left Mounting Bracket
- x1 Passenger/Right Mounting Bracket
- x2 Spacer Plates (2017-19 models only)
- x1 4mm Wrench
- x4 10-1.5mm x 35mm Hex Bolts
- x8 10mm x 27mm OD x 3mm Flat Washers
- x4 10mm Lock Washers
- x4 10mm Hex Nuts
- x2 6-1.0mm x 20mm Combo Bolts (license plate)



TYGER®

STEP 1

Start installation at the driver/left side, front of the vehicle. Remove the plastic cover, (if equipped), covering the bumper bolts on both sides of the tow hook, (Fig 1). Remove the (2) outer bumper bolts, (Figs 2-3).

IMPORTANT: Do not remove the inner bumper bolts or the bumper may fall. Only remove the outer bumper bolts.

NOTE: Cover cannot be reinstalled.



(Fig 1) Remove cover over bumper bolts



Fig 2

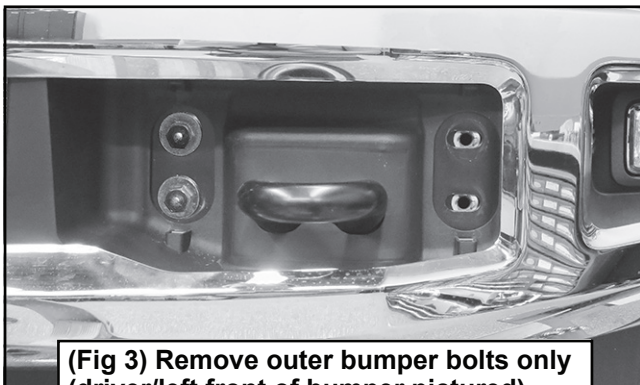

(Fig 3) Remove outer bumper bolts only (driver/left front of bumper pictured)

STEP 2

Select the driver side Mounting Bracket. Determine procedure for your model year.

2017-19 models only:

a. Select (1) Spacer Plate, (Fig 4). Place the Spacer over the holes for the bumper bolts, between the bumper and the Bracket.

b. Reuse the factory bumper bolts to attach the Frame Bracket to the Spacer and bumper, (Fig 5).

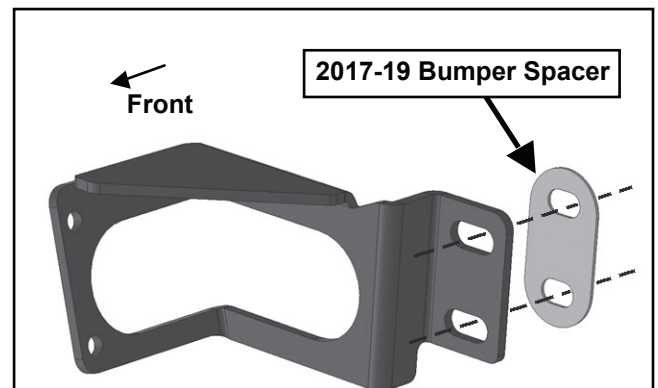

(Fig 4) On 2017-19 models only, attach driver/left Bracket to Spacer and bumper. Do not install Bracket without Spacer on 2017-19 model years

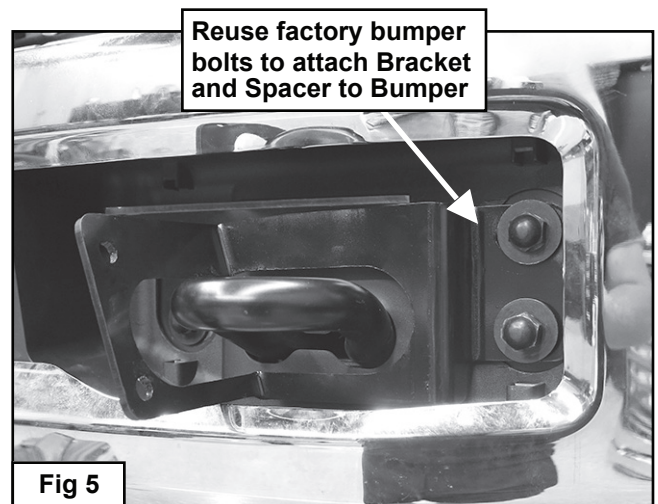

Fig 5

2020 models only:

Reuse the factory bumper bolts to attach the Mounting Bracket to the bumper, note no Spacers are required.



TYGER®

STEP 3

Make sure there is clearance between the top and bottom of the Bracket and the opening in the bumper. Do not tighten hardware at this time.

STEP 4

Repeat Steps 1-3 for passenger side Mounting Bracket and Spacer installation.

STEP 5

With assistance, position the Tyger Guard onto the outside of the (2) Mounting Brackets.

NOTE: Move the Mounting Brackets in or out to line up with the mounting tabs on the Tyger Guard.

STEP 6

Attach the Tyger Guard to the outside of the Mounting Brackets using the included (4) 10mm x 35mm Hex Bolts, (8) 10mm Flat Washers, (4) 10mm Lock Washers and (4) 10mm Hex Nuts, (Figs 6-7). Snug but do not tighten.

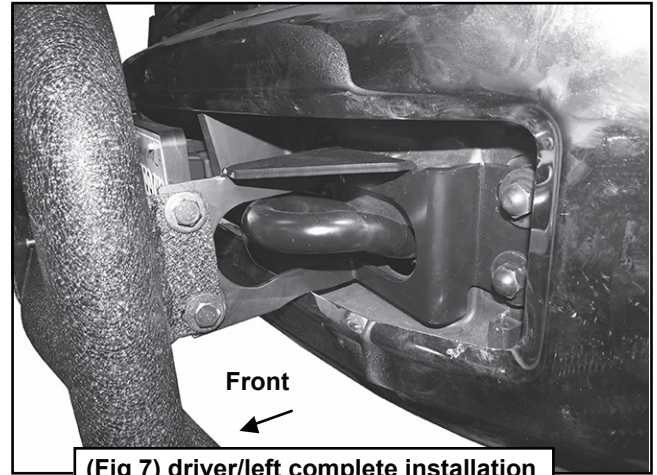
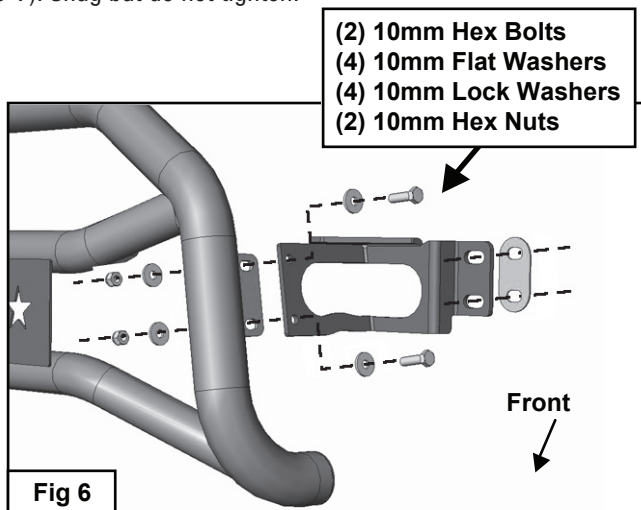

STEP 7

Center the Tyger Guard on the vehicle, level and adjust as desired and tighten all hardware at this time.

STEP 8

Do periodic inspections to the installation to make sure that all hardware is secure and tight.

