



TYGER®

TYGER GUARD™

BEFORE INSTALLATION

READ INSTRUCTIONS CAREFULLY BEFORE STARTING INSTALLATION. REMOVE CONTENTS FROM BOX AND VERIFY ALL PARTS ARE PRESENT. ASSISTANCE IS RECOMMENDED. FAILURE TO IDENTIFY DAMAGE BEFORE INSTALLATION COULD LEAD TO A REJECTION OF ANY CLAIM. IF ANY DAMAGE FOUND, PLEASE TAKE A PICTURE FOR THE CLAIM PURPOSE. PLEASE ALSO SEND THE PICTURES, ORDER NUMBER, AND DETAILS OF THE ISSUE TO SUPPORT@TYGERAUTO.COM.

Torque Value

Fastener Size	Class 8.8 Tightening Torque (ft-lbs)	Class 10.9 Tightening Torque (ft-lbs)
6mm	6-7	6-7
8mm	15-16	22-23
10mm	31-32	44-45
12mm	54-55	78-79
14mm	87-88	125-126

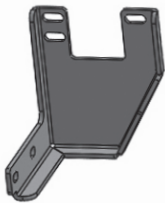
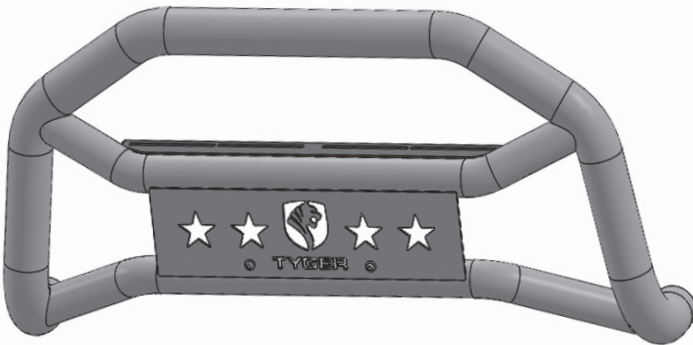

Passenger/right Side Frame Bracket

Driver/left Side Frame Bracket



Passenger/right Side Support Bracket

Driver/left Side Support Bracket



Passenger/right Side Tube Bracket

Driver/left Side Tube Bracket



TG-GD6T60458

Parts List

- x1 Tyger Guard
- x1 Driver/left Frame Mounting Bracket
- x1 Passenger/right Frame Mounting Bracket
- x1 Driver/left side Support Bracket
- x1 Passenger/right side Support Bracket
- x1 Driver/left Tube Mounting Bracket
- x1 Passenger/right Tube Mounting Bracket
- x4 10-1.5mm x 35mm Hex Bolts
- x8 10mm x 27mm OD x 3mm Flat Washers
- x4 10-1.5mm Nylon Lock Nuts
- x6 10-1.5mm Flange Nuts
- x4 8-1.25mm x 35mm Hex Bolts
- x4 8mm x 22mm x 2mm Flat Washers
- x4 8mm Lock Washers
- x2 6-1.0mm x 20 Combination Bolts(license plate)
- x1 4mm Allen Wrench



TYGER®

STEP 1

From under the front passenger/left side of the vehicle, remove (3) factory hex flange nuts, (2 to the outside, 1 to the inside of frame channel), securing the bumper bracket to the end of the frame channel, (Fig 1).

NOTE: Only remove the (3) factory hex nuts required to install the Mounting Bracket.

STEP 2

Select the passenger/right Frame Mounting Bracket and Support Bracket, (Fig 3). Use (2) 10mm Flange Nuts to attach the Frame Bracket to the top (2) threaded studs on the frame, (Fig 3).

STEP 3

Next, attach the Passenger/right Support Bracket to the lower outer stud on the frame and Frame Bracket using the remaining 10mm Flange Nut, (Fig 3). Do not tighten hardware at this time.

STEP 4

Repeat Steps 1-3 to install the driver/left side Frame Bracket and Support Bracket, (Fig 2).

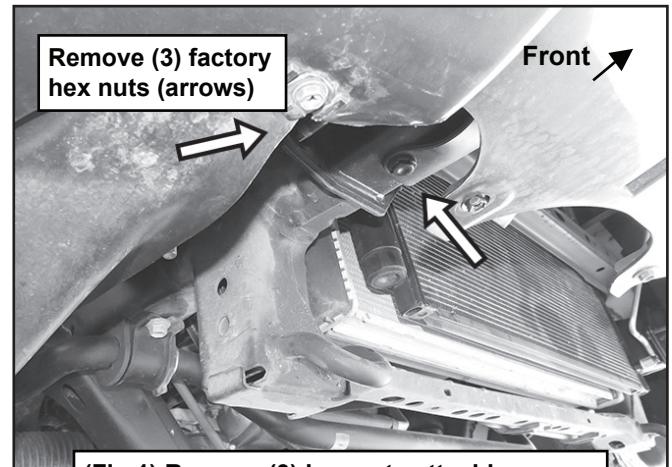

(Fig 1) Remove (3) hex nuts attaching passenger/right bumper bracket to end of frame

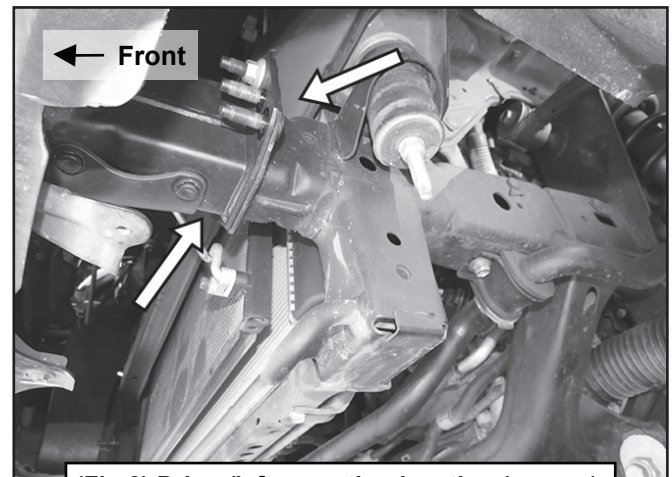

(Fig 2) Driver/left mounting location (arrows)

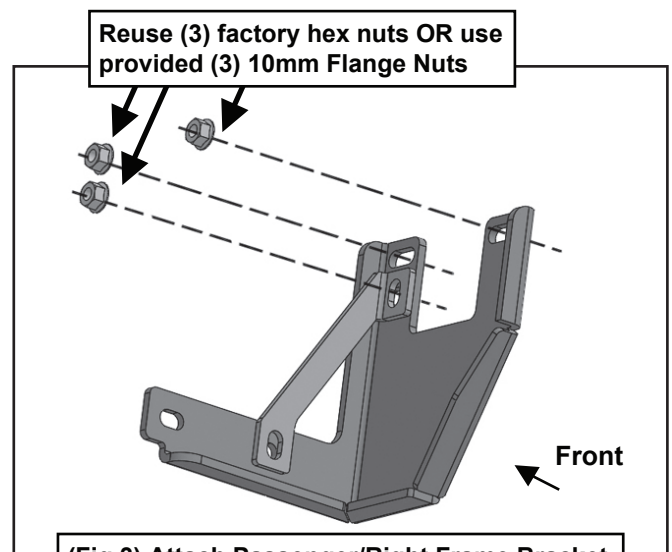

(Fig 3) Attach Passenger/Right Frame Bracket and Support Bracket to end of frame



STEP 5

Next, select the passenger/right Tube Mounting Bracket, (Fig 4). Slide the Bracket between the Frame and Support Bracket, (Fig 4). Align the slots on the Tube Bracket to the slots on the Frame Bracket. Attach the Tube Bracket to the Frame and Support Bracket using (4) 10mm x 35mm Hex Bolts, (8) 10mm Flat Washers and (4) 10mm Nylon Lock Nuts, (Figs 5-6). Do not tighten.

STEP 6

Repeat Step 5 to attach the driver/left side Tube Bracket to the Frame and Support Bracket.

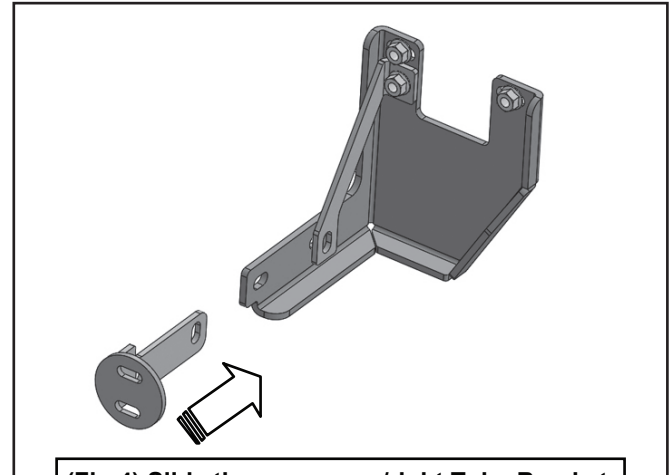

(Fig 4) Slide the passenger/right Tube Bracket between the Frame and Support Bracket

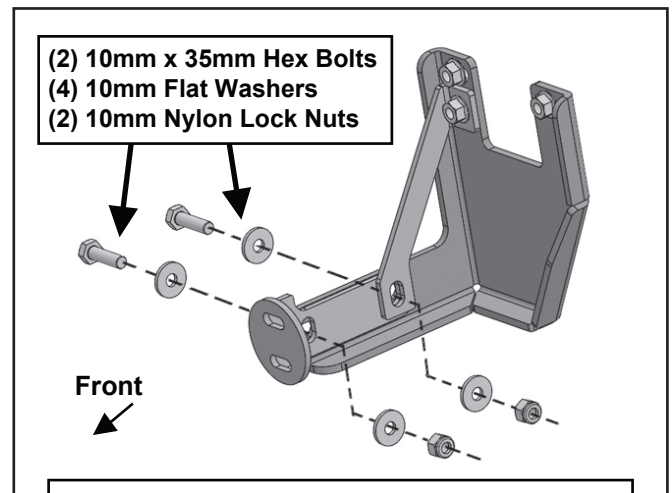

(Fig 5) Attach the passenger/right Tube Bracket to the Frame and Support Bracket

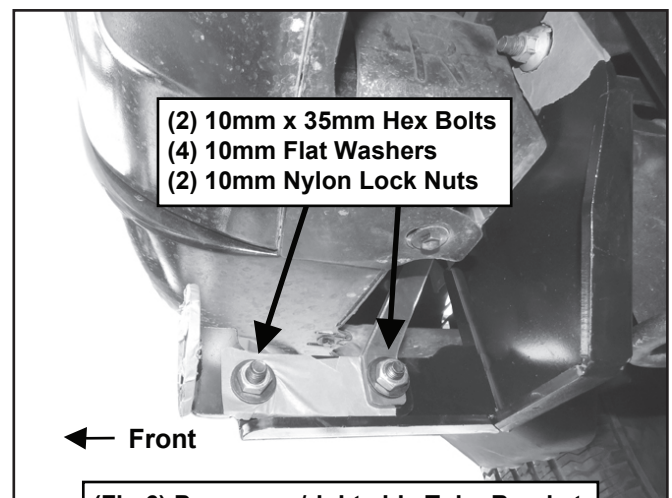

(Fig 6) Passenger/right side Tube Bracket attached to the Frame & Support Bracket



TYGER®

STEP 7

With assistance, attach the TYGER Guard to the ends of the Tube Brackets using (4) 8mm x 35mm Hex Bolts, (4) 8mm Lock Washers and (4) 8mm Flat Washers, (Figures 7-8). Do not fully tighten hardware at this time.

STEP 8

Level and adjust the TYGER Guard and tighten all hardware.

STEP 9

Use the included (2) 6mm x 20mm Combo Bolts to attach the license plate to the TYGER Guard.

STEP 10

Do periodic inspections to the installation to make sure that all hardware is secure and tight.

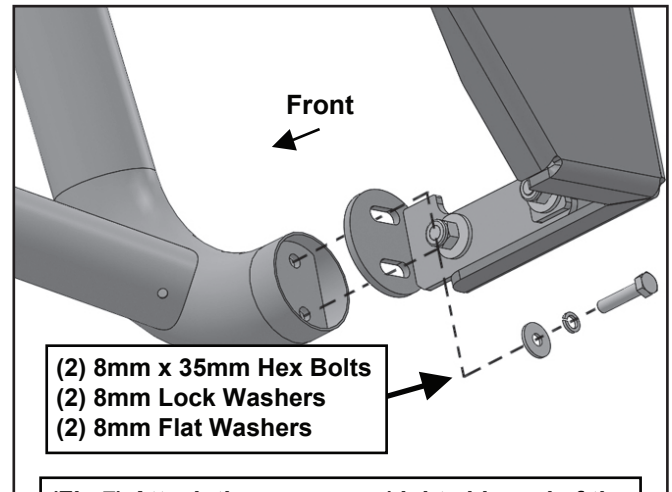

(Fig 7) Attach the passenger/right side end of the tube on the TYGER Guard to the Tube Bracket

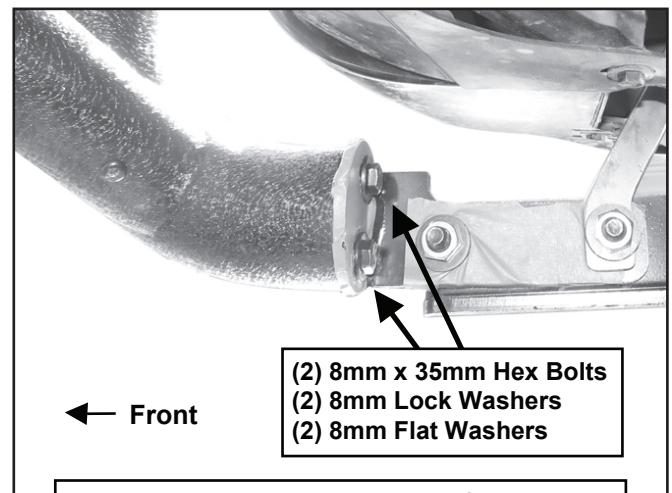

(Fig 8) Passenger/right side end of tube on the TYGER Guard attached to the Tube Bracket

