



TYGER®



TG-HC2J001K:
FOR 2007-UP Wrangler JK 2DR & 4DR

Parts List

- | | |
|--------------------------|------------------------|
| x1 Receiver Hitch | x8 Flat Washers |
| x4 Mounting Bolts | x1 Hitch Cover |
| x4 Nylock Nuts | x1 Wiring Kit |

Tow Rating

2 DR JK (Up to 2000lbs)

4 DR JK (Up to 3500lbs)

Before Installation

If your vehicle is equipped with a tow hook, it must first be removed from the vehicle. There are 3 bolts holding the rear tow hook to the rear cross member. These must be removed, and the tow hook slid down off the cross member.

Warning

- Do not exceed the above-stated tow rating for each model or it will void warranty.
- The Receiver Hitch installs very close to the muffler, which can get very hot. Please ensure that the vehicle is cool before attempting to install.
- If you are unclear with the installation, please seek professional advice to avoid damages.

STEP 1

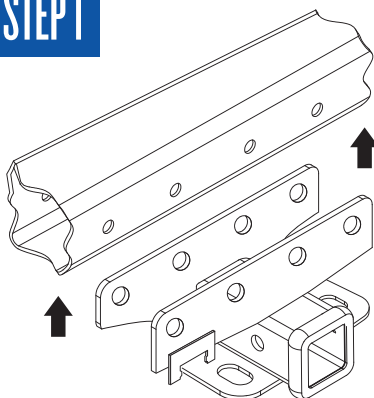

Slide the receiver over the rear crossmember, taking care to align the 4 holes in the receiver with the 4 holes in the cross member. Once in place, insert left or right most bolt with flat washer into the back side of the hitch and through the cross member. Place the nylock nut and flat washer on to the bolt. Secure but do not tighten.

STEP 2

Once all 4 bolts and nylocks nuts have been started, tighten them. The nuts will need to be held in place with an open end wrench. Torque all 1/2" bolts to 110 lb-f. (For Rubicon X & 10th Anniversary models, use factory bolts instead of supplied bolts.)

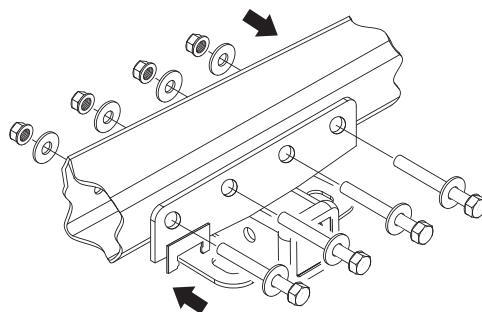

STEP 3

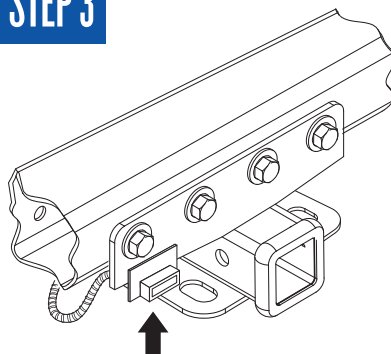

Insert the trailer wiring, if equipped, into the trailer wiring mounting tab on the receiver as shown. Installation is now complete.



TYGER[®]



TG-HW2J001B

WIRING KIT INSTALLATION

STEP 1

Place vehicle in gear and arm the emergency break. Remove rear driver's side taillight.



STEP 2

Disconnect taillight connector as shown.



STEP 3

Connect new loom to male and female connectors.

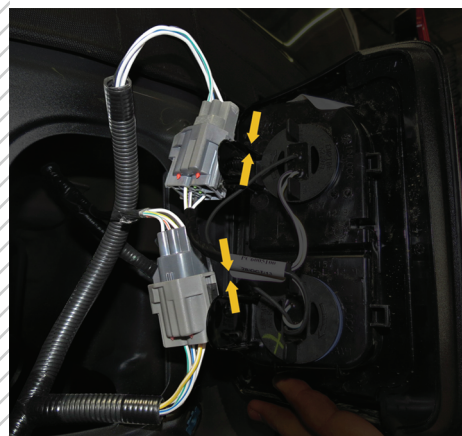

STEP 4

Fish trailer connector down through taillight opening and past foam isolator panel.



STEP 5

After pulling loom through foam isolator drop connector over frame and insert into the tow hitch plug notch.



STEP 6

Locate small 8mm holes drilled along frame and press in retainer clips. Test all light functions before towing.

