



TYGER®

SPORT BAR

TG-SB7F88468

BEFORE INSTALLATION

READ INSTRUCTIONS CAREFULLY BEFORE STARTING INSTALLATION. REMOVE CONTENTS FROM BOX AND VERIFY ALL PARTS ARE PRESENT. FAILURE TO IDENTIFY DAMAGE BEFORE INSTALLATION COULD LEAD TO A REJECTION OF ANY CLAIM. IF MISSING PARTS OR ANY DAMAGE FOUND, PLEASE TAKE A PICTURE FOR THE CLAIM PURPOSE. TO FILE YOUR CLAIM, PLEASE VISIT: WWW.TYGERAUTO.COM/CONTACT

TORQUE VALUES

Fastener Size	Class 8.8 Torque (ft-lbs)	Class 10.9 Torque (ft-lbs)
6mm	6-7	6-7
8mm	15-16	22-23
10mm	31-32	44-45
12mm	54-55	78-79
14mm	87-88	125-126

Parts List

- x1 Front Cross Tube
- x1 Driver/Left Cross Tube
- x1 Passenger/Right Cross Tube
- x1 Driver/Left Base Bracket
- x1 Passenger/Right Base Bracket
- x1 Driver/Left Decorative Plate
- x1 Passenger/Right Decorative Plate
- x1 Driver/Left Logo Plate
- x1 Passenger/Right Logo Plate
- x2 L-Brackets
- x1 Driver/Left Plastic Sleeve
- x1 Passenger/Right Plastic Sleeve
- x4 Plastic Base Covers
- x2 Rubber Plugs
- x4 12-1.75mm x 35mm Flat Head Bolt
- x2 12-1.5mm x 60mm Button Head Bolts
- x2 12mm Lock Washers
- x2 12mm x 24mm OD x 2.5mm Flat Washers
- x6 8-1.25mm x 40mm Hex Bolts
- x2 8-1.25mm x 25mm Hex Bolts
- x2 8-1.25mm x 16mm Hex Bolts
- x12 8mm x 24mm OD x 2mm Flat Washers
- x10 8mm Lock Washers
- x2 8mm Hex Nuts
- x6 8mm Nut Plates
- x2 6-1.0mm x 20mm Button Head Combo Bolts
- x8 6mm Flange Nuts
- x1 8mm Hex Wrench
- x1 4mm Hex Wrench
- x1 12mm Fish Wire

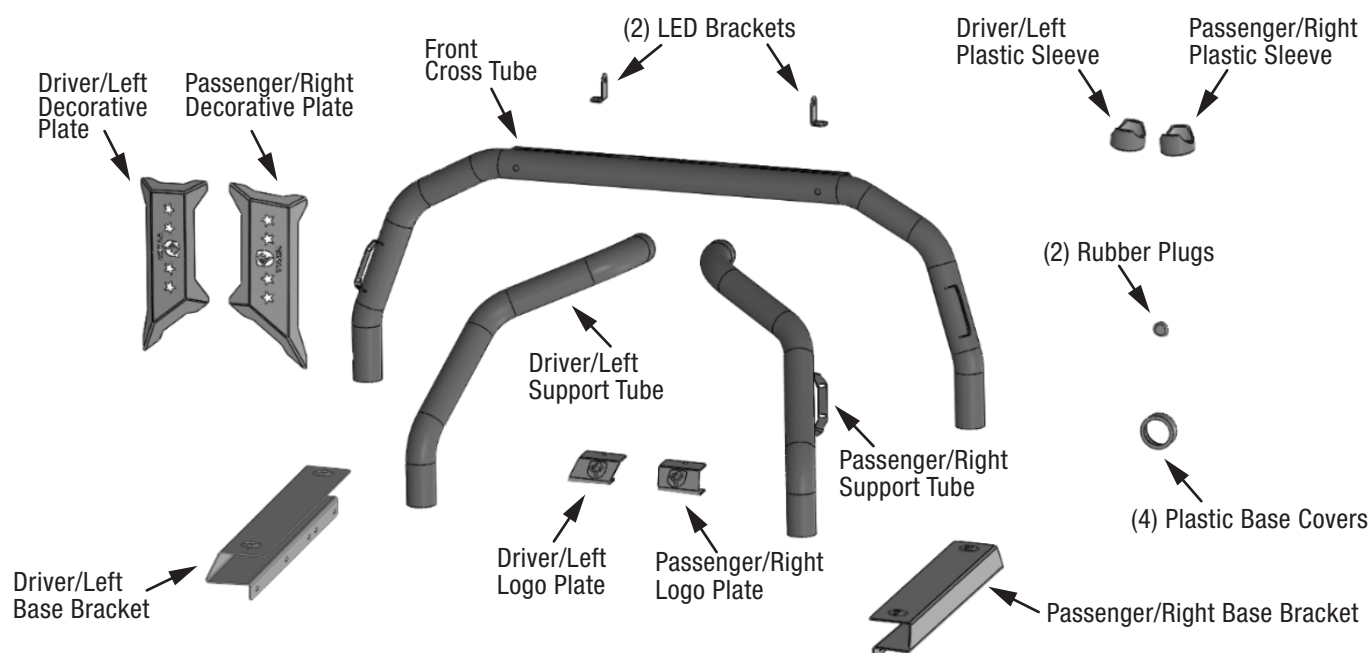



TYGER®

PROCEDURE:

REMOVE CONTENTS FROM BOX. VERIFY ALL PARTS ARE PRESENT. READ INSTRUCTIONS CAREFULLY BEFORE STARTING INSTALLATION. ASSISTANCE IS RECOMMENDED. DRILLING IS REQUIRED. CUTTING OF PLASTIC BED LINER (IF EQUIPPED) MAY BE REQUIRED.

STEP 1

Select the Front Cross Tube. Insert (1) 12mm Button Head Bolt into (1) 12mm Lock Washer and (1) 12mm Flat Washer. Thread the bolt assembly into the 12mm Fish Wire, (Fig 1). Slide the Fish Wire assembly through the holes in the Front Cross Tube, (Figs 2 & 3). Insert 8mm Hex Wrench into the head of the bolt to hold it in place inside the tube, (Fig 4).

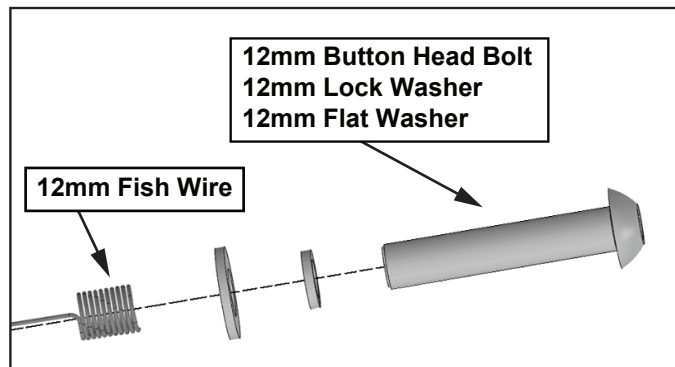

(Fig 1) Thread 12mm assembly into the 12mm Fish Wire

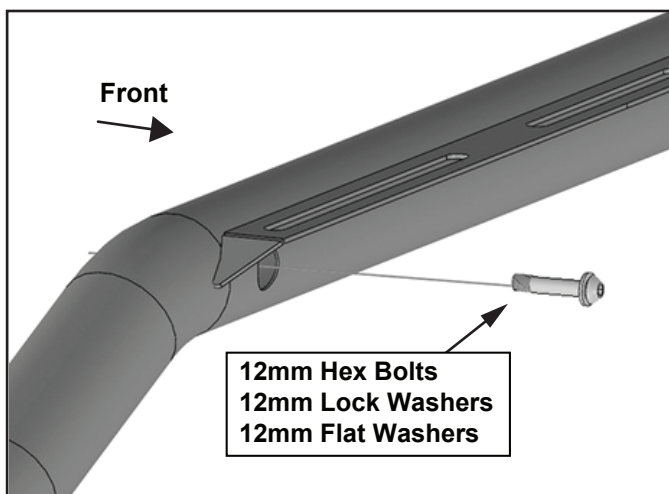

(Fig 2) Use Fish wire to pull 12mm Hex Bolt into the Front Cross Tube

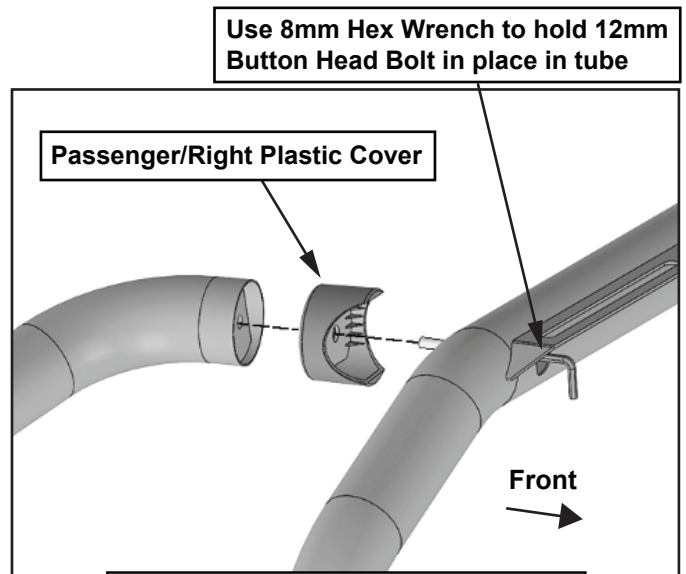
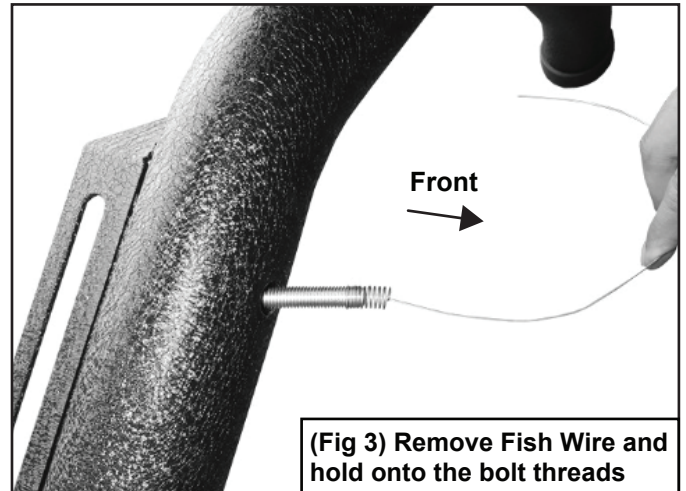

(Fig 4) Passenger/Right Support Tube installation to Front Cross Tube

STEP 2

Slide the Passenger/ Right Plastic Sleeve onto the Passenger/Right Rear Support Tube. Thread the 12mm Button Head Bolt into the Passenger/Right Support Tube, (Figs 4 & 5).



TYGER®

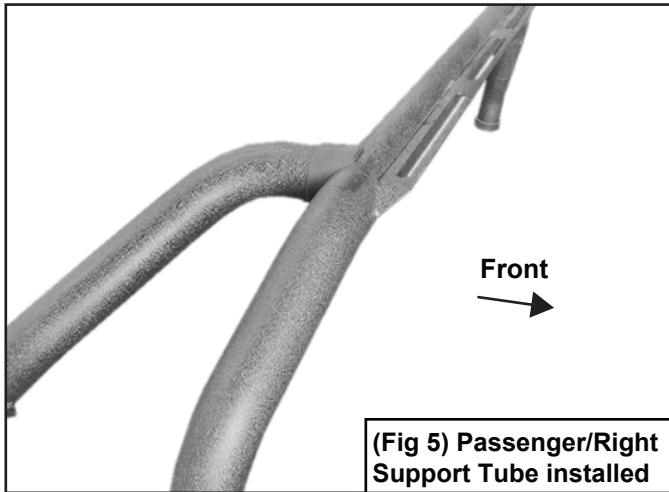

STEP 3

Repeat **STEPS 1 & 2** to attach the Driver/Left Rear Support Tube. DO NOT tighten hardware at this time.

STEP 4

Slide (2) Plastic Base Covers onto the bottom of the Passenger/Right tubes. Select the Passenger/Right Base Bracket. Attach the Base Bracket to the bottom of the Tubes with (2) 12mm Flat Head Bolts, (Fig 6). DO NOT tighten hardware at this time. Repeat this Step to attach the Driver/Left Base Bracket.

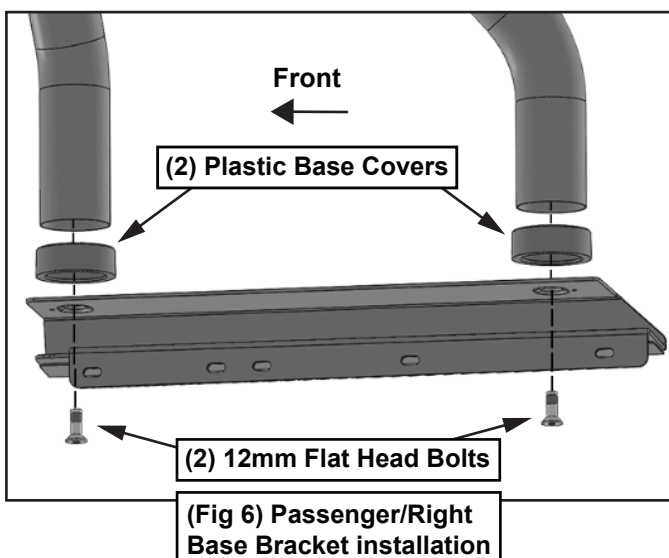

STEP 5

Select the Passenger/Right Decorative Plate. Attach the Decorative Plate to the welded brackets on the sides of the Tubes with (4) 6mm Flange Nuts, (Figs 7 & 8). Repeat this **STEP** to attach the Driver/Left Decorative Plate. DO NOT tighten hardware at this time.

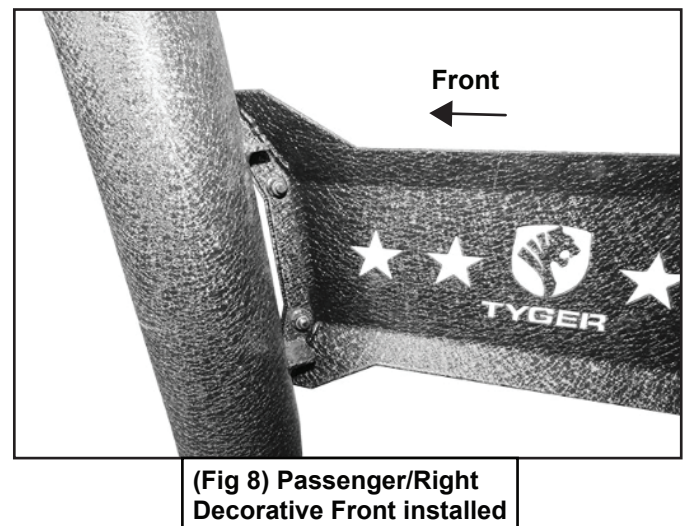
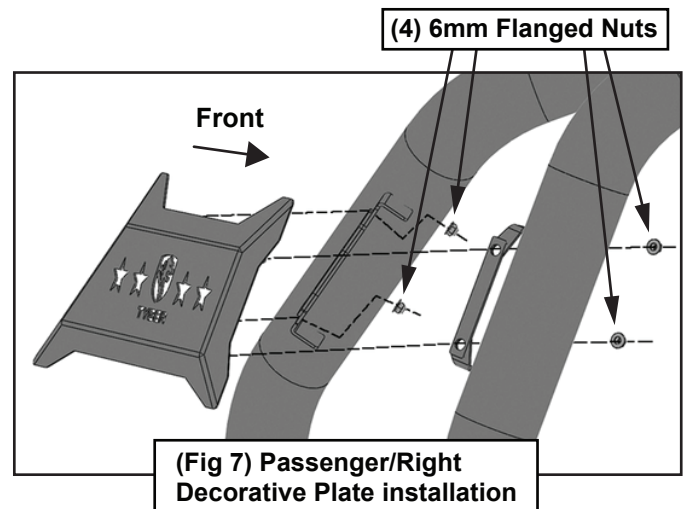

STEP 6

With assistance, place the Sports Bar assembly onto the desired position on the bed of the vehicle. The Front Cross Tube should be at least 30mm away from the rear of the cab, (Fig 9).



TYGER[®]

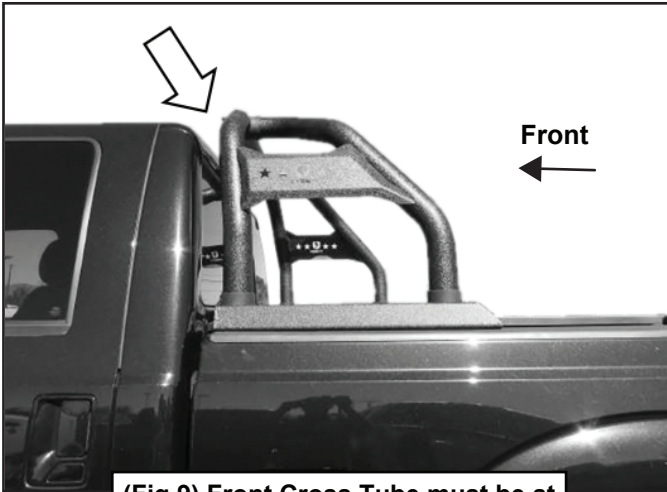

(Fig 9) Front Cross Tube must be at least 30mm from the rear of the cab

STEP 7

Mark the holes in the Base Brackets to determine locations to drill holes in the lip of the bed. DO NOT mark locations with plastic tabs underneath the lip of the bed, (Fig 10).

For 1999—2016 models:

a. Mark the 1st, 3rd, 4th and 5th slot for drilling, (Fig 11a).

For 2017—2020 models:

a. Mark the 2nd, 3rd, 4th and 5th slots for drilling, (Fig 11b).

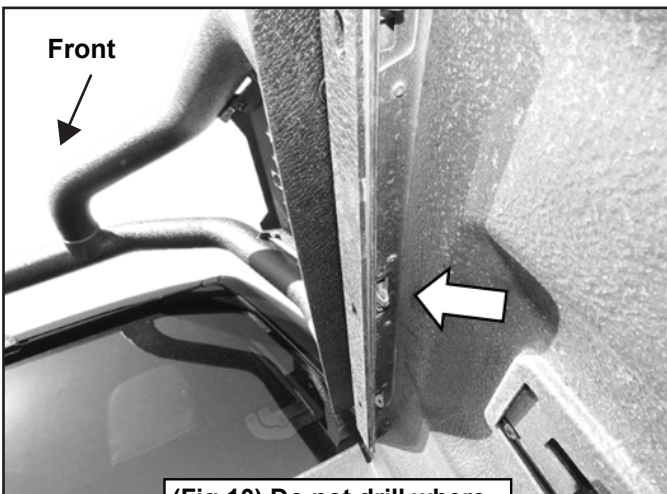

(Fig 10) Do not drill where the plastic tabs are located

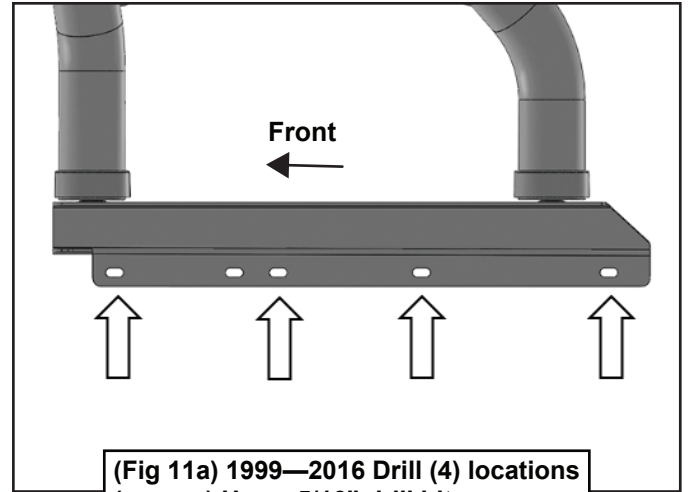

(Fig 11a) 1999—2016 Drill (4) locations (arrows) Use a 5/16" drill bit

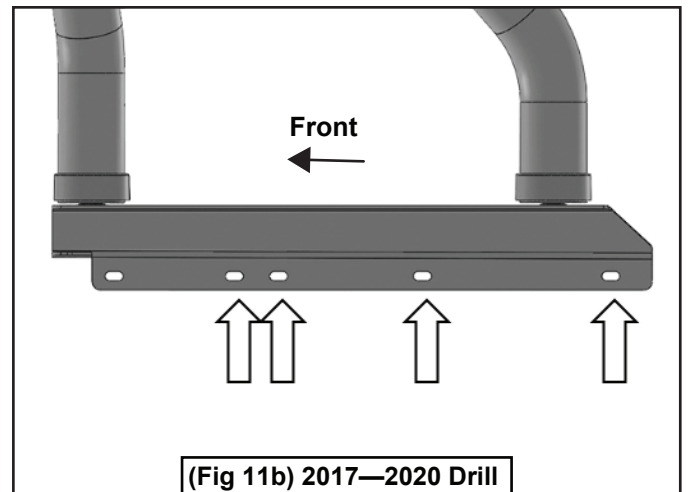

(Fig 11b) 2017—2020 Drill (4) locations (arrows)

STEP 8

Temporarily remove the Sports Bar. Using a 5/16" drill bit, drill holes for mounting. **IMPORTANT:** DO NOT drill too close to the edge of the bed or at the location of the plastic tabs under the lip of the bed, (Fig 10). Repeat this **STEP** for the Driver/Left side. To Prevent rust, apply a thin layer of paint.



TYGER®

STEP 9

Attach Sports Bar assembly to the bed with (8) 8mm x 40mm Hex Bolts, (8) 8mm Lock Washers, (8) 8mm Flat Washers and (8) 8mm Nut Plates (Behind the top of the bed), (Fig 12).

(4) 8mm x 40mm Hex Bolts
(4) 8mm Lock Washers
(4) 8mm Flat Washers
(4) 8mm Nut Plates

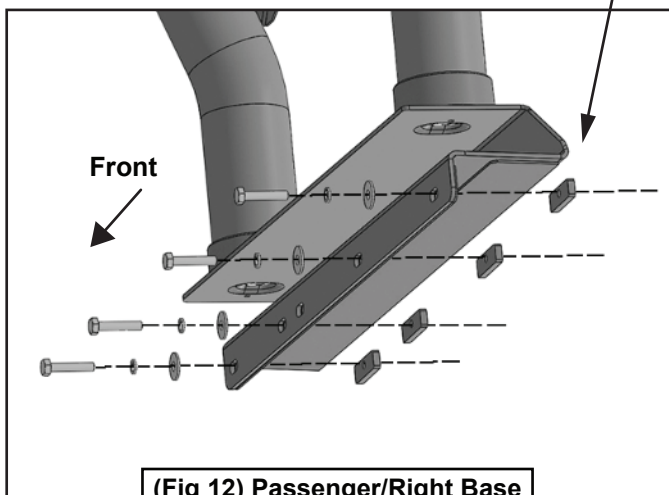

(Fig 12) Passenger/Right Base Bracket to bed installation

STEP 10

Level and center the Sports Bar. Tighten all hardware.

STEP 11

Select (2) Rubber Plugs. Insert Plugs into the front holes of the Front Cross Tube, (Fig 13).

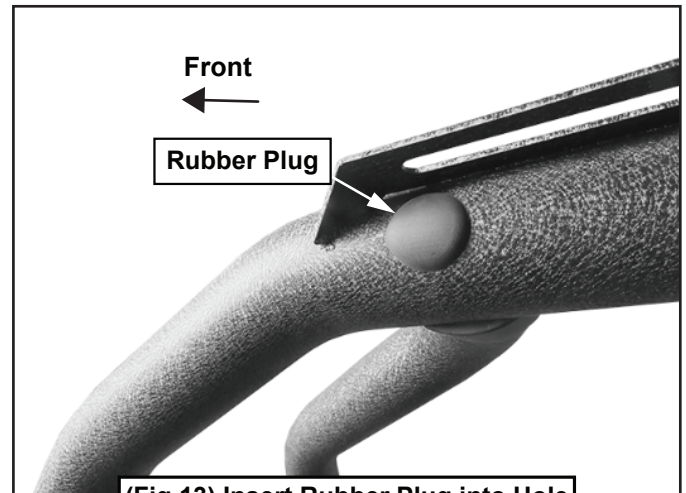

(Fig 13) Insert Rubber Plug into Hole

STEP 12

(Optional to attach a Light Bar) Select (1) L-Bracket. Attach to the Passenger/Right top of the Sports Bar with (1) 8mm x 25mm Hex Bolt, (2) 8mm Flat Washers, (1) 8mm Lock Washer and (1) 8mm Hex Nut, (Fig 14). Repeat this **STEP** to attach (1) L-Bracket to the Driver/Left side.

8mm x 25mm Hex Bolt
(2) 8mm Flat Washers
8mm Lock Washer
8mm Hex Nut

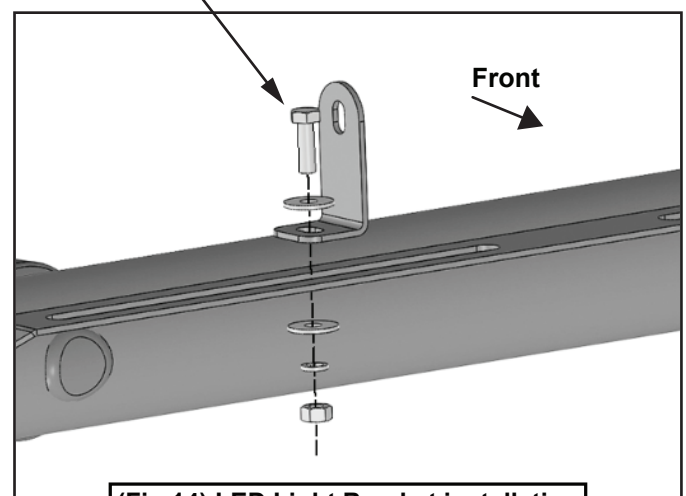

(Fig 14) LED Light Bracket installation



TYGER®

STEP 13

Attach Light Bar (sold separately) to the L-Brackets with (2) 8mm x 16mm Hex Bolt, (2) 8mm Lock Washer and (2) 8mm Flat Washer, (Fig 15).

8mm x 16mm Hex Bolt
8mm Lock Washer
8mm Flat Washer

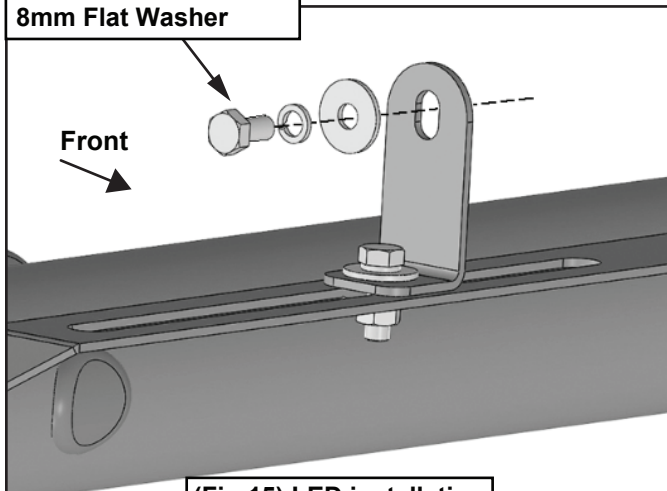

(Fig 15) LED installation

STEP 14

(OPTIONAL) Locate the threaded mounting hole on the inside of the Base Bracket for the Passenger/Right Logo Plate. Attach Logo Plate with one 6mm Combo Bolt, (Figs 16—18). Repeat this Step to attach the Driver/Left Logo Plate. **DO NOT** attach Plates if a tonneau cover will be installed.

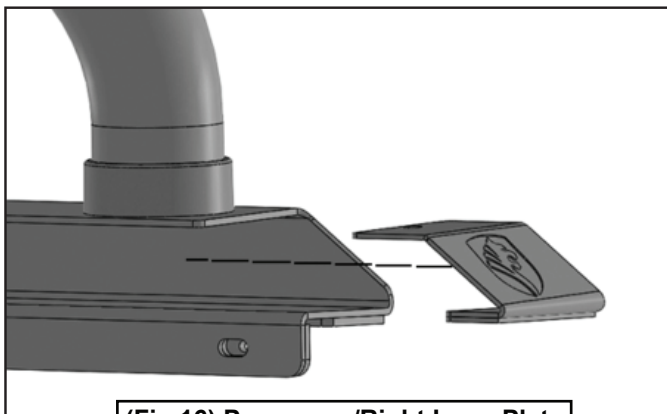

(Fig 16) Passenger/Right Logo Plate

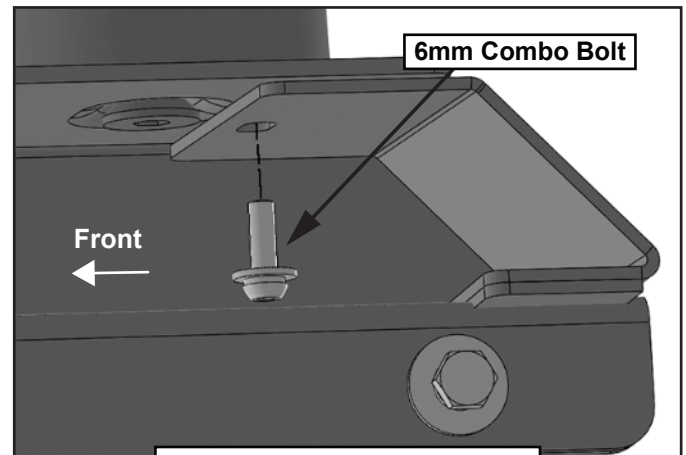

(Fig 17) Passenger/Right Logo Plate installation (Optional)

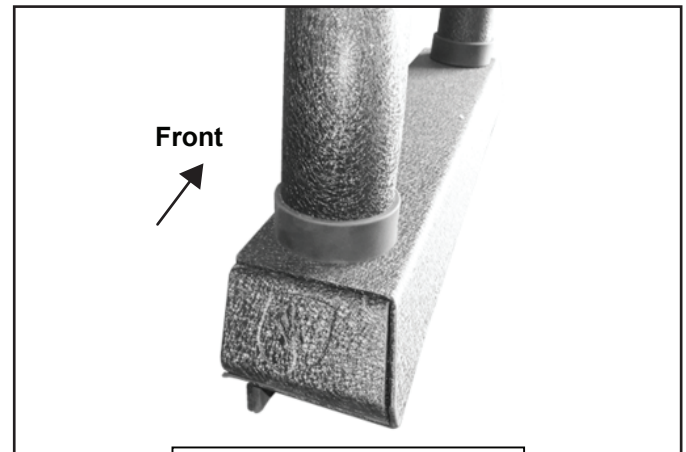

(Fig 18) Logo Plate installed

STEP 15

Do periodic inspections to the installation to make sure that all hardware is secure and tight.