

# AT-6506SP

SPORT MUFFLER - SLIP-ON  
1999-2002 POLARIS MAGNUM 500

# MBRP

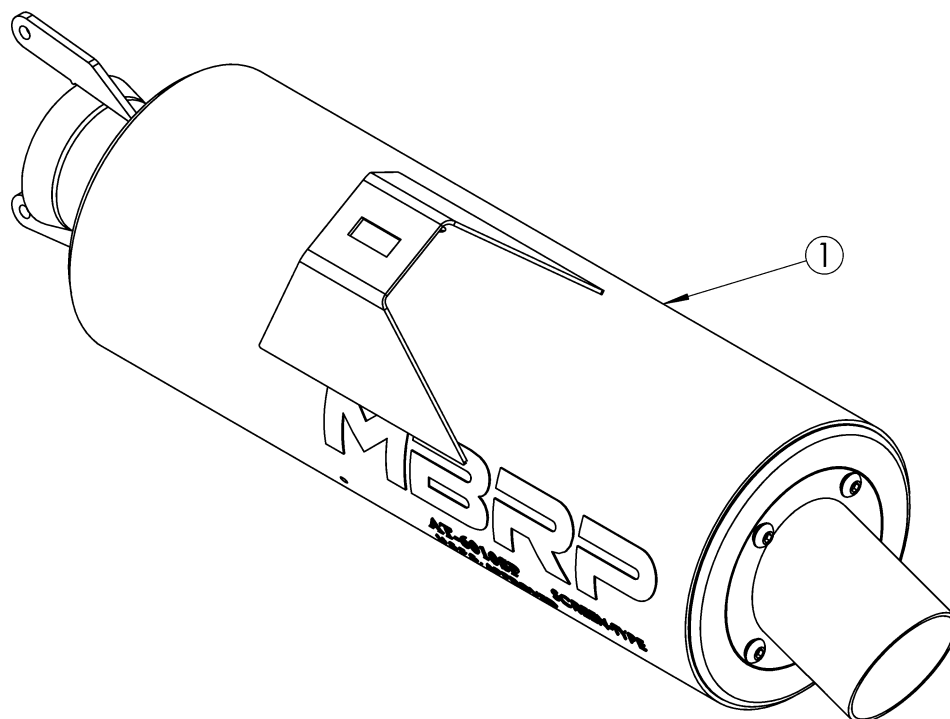

1. MUFFLER ASSEMBLY

## PLEASE READ BEFORE STARTING INSTALLATION

While MBRP Inc. has made every effort to ensure that all components of this system are of superior quality and properly packaged, it is the installer's responsibility to ensure the following before removal of the factory exhaust:

- that ALL components shown above are present.
- that ALL mating components fit together.
- that there are no damaged components.
- that the system you have purchased is appropriate for your vehicle year, model and configuration.
- that the system will not interfere with any modifications previously installed or planned.
- that you have read and understand these instructions.

If you have any questions or are uncertain about any aspect of the installation of this system to your vehicle please contact your dealer before commencing installation.



### **Removal of Stock Exhaust**

1. Remove the springs securing the main muffler inlet to the exhaust pipe. Do not discard springs or the gasket.
2. Remove bolts attaching the muffler to the bike and remove the muffler. Do not discard the bolts.

### **Installation of MBRP Exhaust**

1. Place the previously removed gasket onto the inlet pipe of the **Muffler**.
2. Position the exhaust onto the gasket, aligning the **Muffler** bracket.
3. Install the previously removed bolts loosely. Then attach the springs. Afterwards go back and finish tightening the bolts.

**Congratulations!** You are ready to begin experiencing the improved performance and driving excitement of your **MBRP** Ltd. ATV Exhaust upgrade. We know you will enjoy your purchase.



**Figure 1**



**Figure 2**



**Figure 3**



**Figure 4**

## Spark Arrester Maintenance

In order to maintain optimal performance, the spark arrester screen should be cleaned every 30-35 hours of use.

### Clean-out Instructions:

Make sure the vehicle is cool before completing the clean-out procedure.

1. Using a 1/8" hex key, remove the 4 screws securing the outlet cap. (Figure 1).
2. Remove the outlet cap to expose the spark arrester screen insert. (Figure 2)
3. Remove the screen insert. (Figure 3)
4. Using a wire brush, thoroughly brush the screen to remove residue. (Figure 4)
5. Replace the screen and cap.
6. Tighten the screws to 23 in-lbs (2.6 Nm).