



TYGER®

T1 | SOFT ROLL UP Tonneau Cover



Watch Video Installation Guide:

<https://youtu.be/euPjNKL14Og>

TOOLS REQUIRED (not included)



Ratchet
Wrench



10mm
Socket

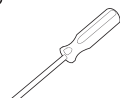

Phillip-Head
Screwdriver



ATTENTION!

READ INSTRUCTIONS CAREFULLY BEFORE STARTING INSTALLATION. REMOVE CONTENTS FROM BOX AND VERIFY ALL PARTS ARE PRESENT. FAILURE TO IDENTIFY DAMAGE BEFORE INSTALLATION COULD LEAD TO REJECTION OF ANY CLAIM.



NEED HELP?

contact us:

1-866-340-3038

ITEMS LIST (ONLY MARKED ITEMS ARE INCLUDED)

☐ **x1** Bed Cover



☐ **x2** Side Rails (L & R)



☐ SP-BC1002B



☐ SP-BC1021



☐ SP-BC1003



☐ SP-BC1004



☐ SP-BC1005B



☐ SP-BC1006B



☐ **SP-BC0003**
Seal Strip
170 x 2.5 x 1cm

☐ **SP-BC0004**
Seal Strip
170 x 3.5 x 0.4cm

☐ **SP-BC0007**
Seal Strip
150 x 3 x 1.6cm



Quantity and shape of clamps
may vary by vehicle model.

Customer Support: www.tygerauto.com/contact

V230818

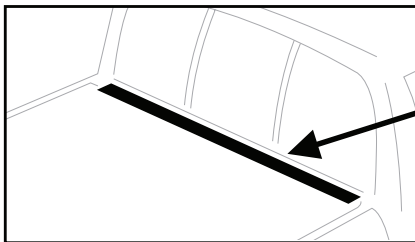

You might need:



Seal Strip

(Only apply to some models)



ATTENTION!

• IF THE TRUCK'S FRONT BED RAIL IS LOWER THAN THE SIDES, USE THE PROVIDED WEATHER SEAL STRIPS. GAPS ON THE FRONT BED AND TAILGATE WILL CAUSE NOISE AND FLAPPING ISSUES WHILE THE VEHICLE IS IN MOTION!

1 ASSEMBLING COVER

- PLACE COVER ASSEMBLY ON FRONT TRUCK BED RAIL AGAINST THE CAB.
- LOOSEN THE SCREW IN BULKHEAD ASSEMBLY ON BOTH SIDES, THEN SLIDE IN THE SIDE RAILS.
- REINSTALL AND TIGHTEN SCREWS TO ATTACH SIDE RAILS TO COVER ASSEMBLY

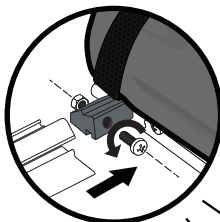
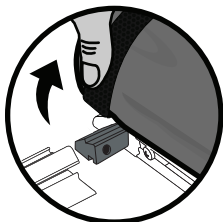

LIFT TARP WHILE INSERTING SIDE RAIL TO PREVENT TEARING.

You will need:



Phillips-Head Screwdriver

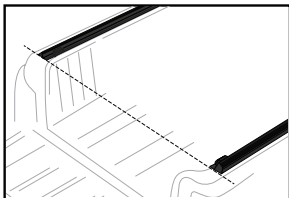
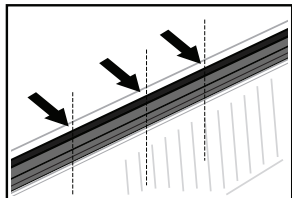
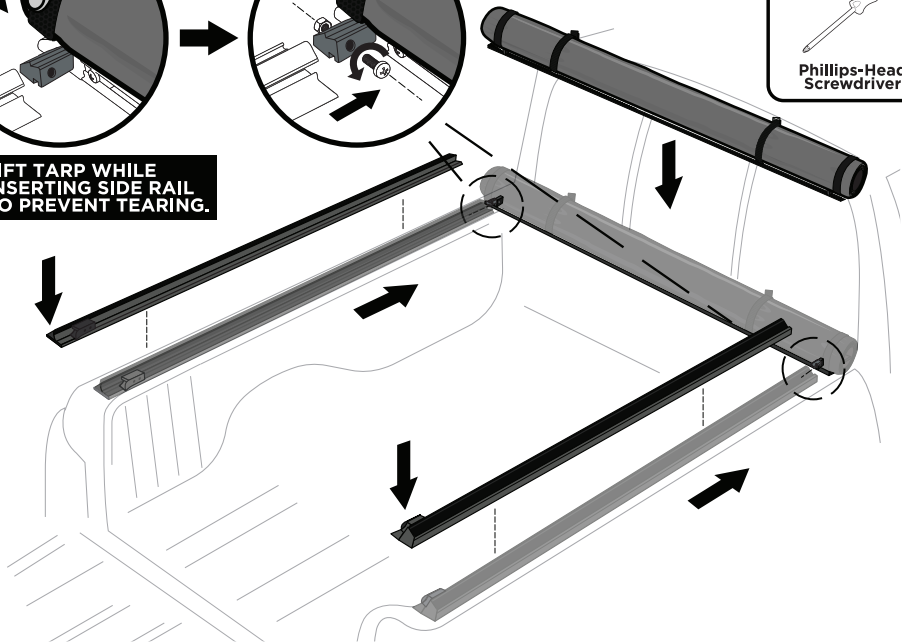

ATTENTION!

• MAKE SURE THE SIDE RAIL LINES UP WITH THE INNER EDGE OF THE TRUCK BED RAIL. PLACE THE SIDE RAILS EVENLY SO THAT THE DISTANCE BETWEEN THE REAR END OF THE SIDE RAIL TO THE TAILGATE IS THE SAME ON BOTH SIDES.

2 POSITIONING SIDE RAILS

- THE NUMBER OF CLAMPS EQUIPPED ON THIS BED COVER IS SPECIFIC TO THE MODEL AND BED SIZE. CONFIRM THE NUMBER (4/6/8) OF CLAMPS INSIDE THE HARDWARE PACKAGE.
- THEN EVENLY PLACE THE SUPPLIED CLAMPS ALONG THE SIDE RAILS ACCORDING TO THE POSITIONAL CONFIGURATION A/B/C BASED ON THE # OF CLAMPS.
- ATTACH THE CLAMPS TO THE SIDE RAIL AND THE TRUCK BED RAILS. DO NOT TIGHTEN CLAMPS UNTIL COVER IS PROPERLY FITTED.

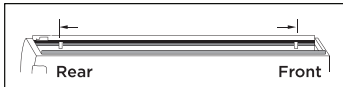
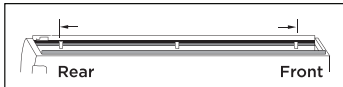
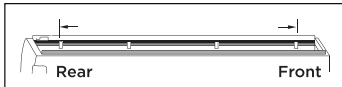
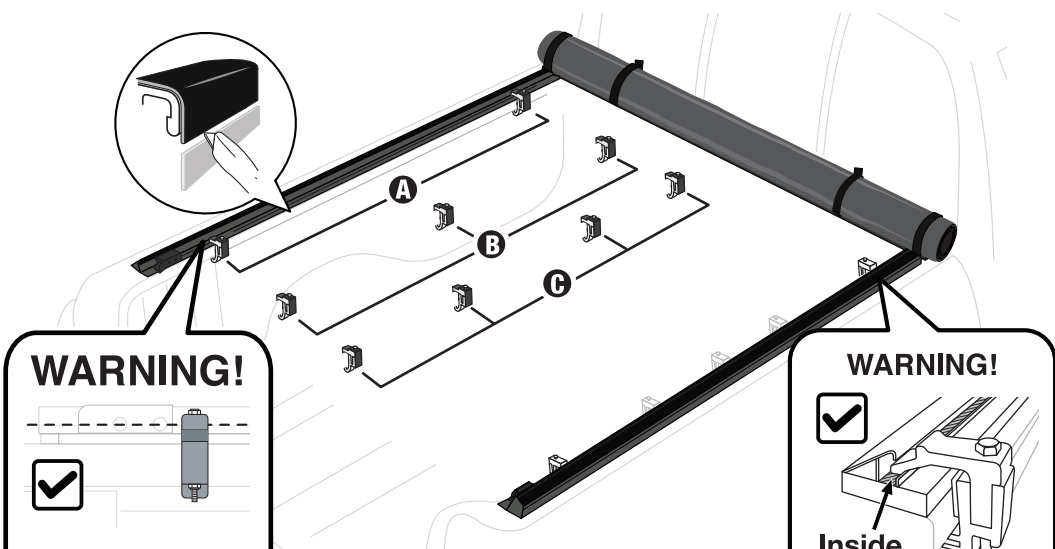
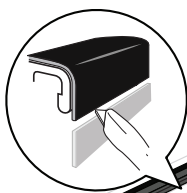
A

4 CLAMPS
B

6 CLAMPS
C

8 CLAMPS

WARNING!



DO NOT
over-tighten
the clamps.

NOTE: FOR TOYOTA AND NISSAN MODELS,
REFER TO **PAGE 7** FOR SUPPLEMENTAL
INSTRUCTION ON UTILITY TRACK BRACKET
INSTALLATION.



ATTENTION!

- CLAMPS MUST BE ATTACHED SECURELY TO THE **METAL PART** OF THE TRUCK BED RAIL LIPS; SMALL HOLES MIGHT NEED TO BE CUT ON THE BED LINER.

WARNING!

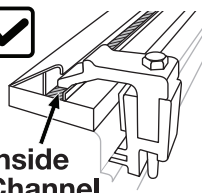

**Inside
Channel**

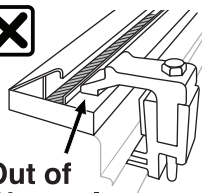

**Out of
Channel**

3 ROLLING DOWN THE COVER

- UNHOOK THE SAFETY STRAPS.
- MAKE SURE THE ENDS OF THE CROSSBAR ARE RESTING ON THE SIDE RAILS AND THE DIRECTION OF THE CROSSBAR IS ARCHED UPWARD.

DO NOT OFFSET THE CROSSBAR OFF THE SIDE RAILS !

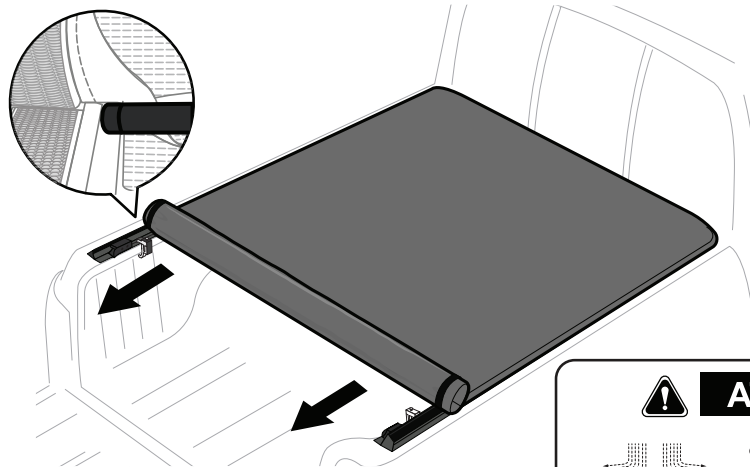

ATTENTION!

Horizontal crossbars are arched by default to help with water drainage. Make sure arched side is up during installation. Incorrect positioning of the crossbar will cause water to pool.

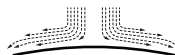

4 LATCHING THE COVER

- PUSH DOWN ON THE END OF COVER TO CLOSE.
- COVER MUST BE LATCHED DOWN PRIOR TO CLOSING THE TAILGATE.

NOTE: FOR LATCHING ISSUE, REFER TO **PAGE 8** FOR TROUBLE SHOOTING INSTRUCTION.

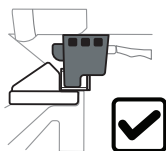
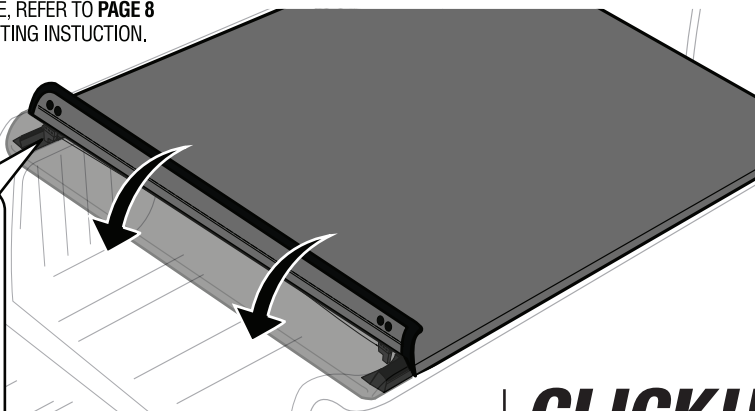

In Channel

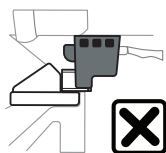

NOT In Channel

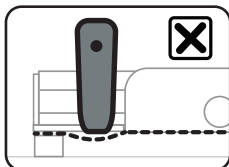

WARNING!

LATCH HEAD THAT IS OUT OF POSITION CAN CAUSE DAMAGE TO THE CHANNEL.

CLICK!!!

NOTE:

YOU SHOULD HEAR A CLICKING SOUND WHEN CLOSING THE COVER TO INDICATE THE COVER IS PROPERLY LATCHING DOWN.

5

FINISHING THE INSTALLATION

- GENTLY PULL ON BOTH SIDES OF THE COVER. PRESS ALONG THE EDGES TO SECURE THE VELCRO.

COMPLETED!!!

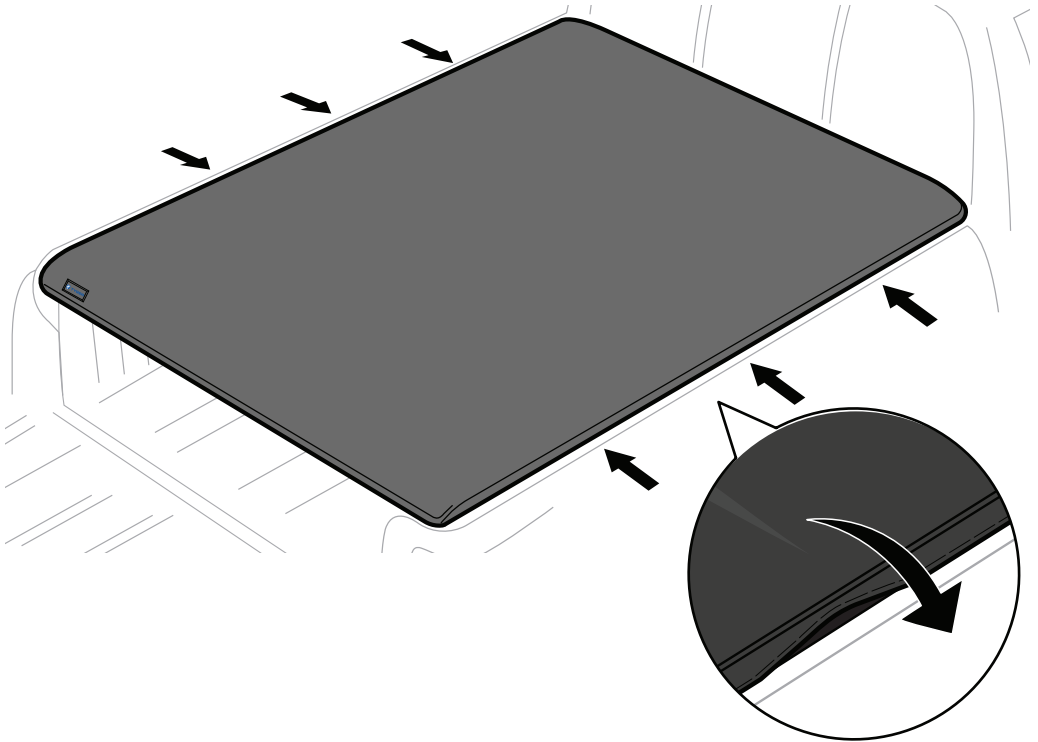

6

UNLATCHING THE COVER

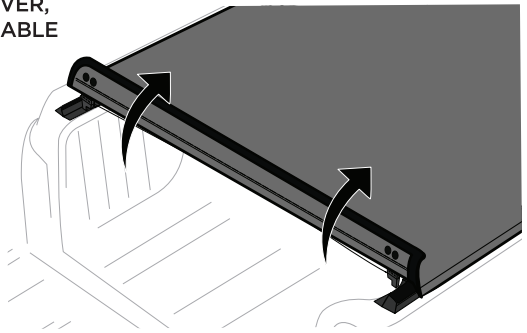
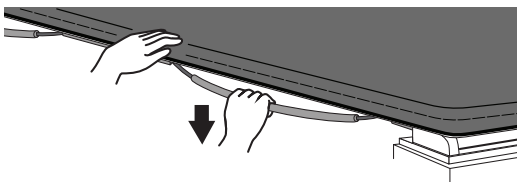
- PUSH DOWN ON THE END OF THE COVER, PULL ON EITHER SIDE OF THE LATCH CABLE TO UNLATCH THE COVER.

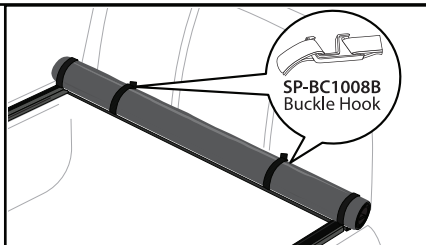
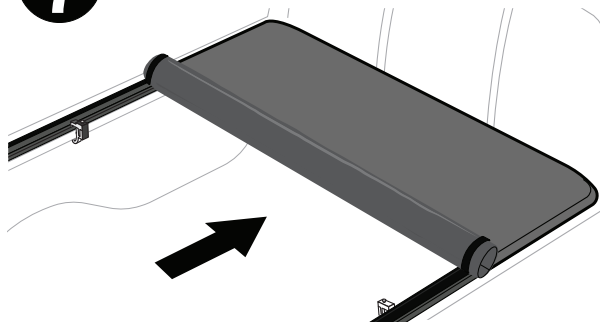

7 ROLLING UP THE COVER



ATTENTION!

- MAKE SURE THE COVER IS FREE OF ANY DEBRIS BEFORE ROLLING UP THE COVER. SAFETY STRAPS MUST BE SECURED BEFORE DRIVING AFTER YOU ROLLED UP THE COVER.



DO NOT
OVERLOAD CARGO



REMOVE SNOW BEFORE
ROLLING UP COVER



SECURE ALL CLAMPS
BEFORE DRIVING



USE WATER AND SOAP
TO CLEAN, AVOID ABRASIVE
CHEMICAL CLEANERS

NOTE: COVER MAY NOT COMPLETELY COVER TO THE OUTSIDE EDGE OF THE BED RAILS DUE TO SLIGHT DIFFERENCE IN TRUCK BED SHAPE FOR DIFFERENT YEAR MODELS.

8 THE TENSION CONTROL SYSTEM

- DEPENDING ON THE WEATHER CONDITION IT MAY BE NECESSARY TO ADJUST THE TENSION CONTROL SYSTEM. TO ADJUST, LOOSEN THE PHILLIP SCREWS ON THE TENSION PLATE, THEN THE TENSION PLATE CAN BE SLIDED BACK AND FORTH.

NOTE: ONLY MOVE ONE INCREMENT AT A TIME. SAME ADJUSTMENT TO BOTH TENSION PLATES IS NEEDED.

You will need:



Phillips-Head
Screwdriver



SP-BC1013C
Tension Plate

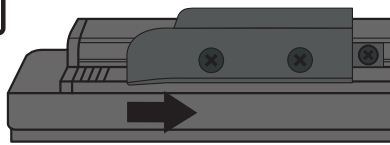
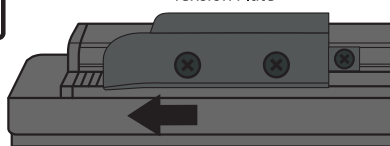

NOTE: DO NOT ADJUST TENSION PLATE BEYOND THE LAST INCREMENT LINE.

SPECIAL INSTRUCTIONS FOR ALTERNATIVE BRACKETS

SUPPLEMENT TO INSTALLATION INSTRUCTIONS
(Only for models with utility track)

For NISSAN TITAN

You will need:



SP-BC1003

a

Slide aluminum
blocks into
the utility track

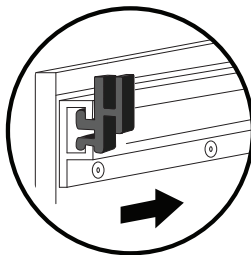

b

Tighten
The clamp

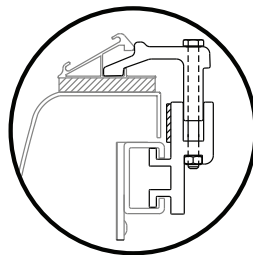

For NISSAN FRONTIER (Only up to 2021 model year)

You will need:



SP-BC1004

a

Slide aluminum
blocks into
the utility track

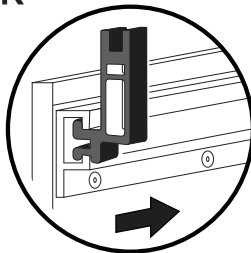

b

Tighten
The clamp

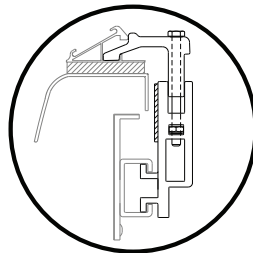

For TOYOTA TACOMA

You will need:



SP-BC1005B

a

Slide aluminum
blocks into
the utility track

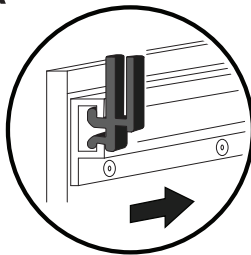

b

Tighten
The clamp

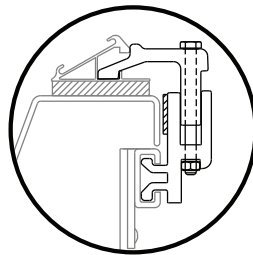

For TOYOTA TUNDRA

You will need:



SP-BC1006B

a

Slide aluminum
blocks into
the utility track

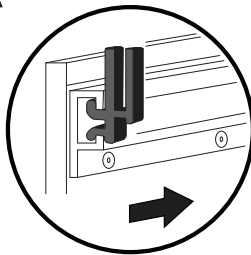

b

Tighten
The clamp

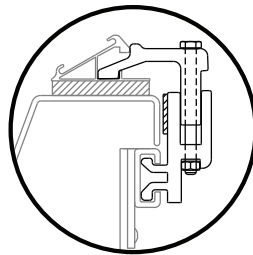

COVER DOESN'T STAY LATCHED?

9

- MAKE SURE THE LOCKING CLIP ON BOTH SIDES ARE COMPLETELY INSERTED INTO THE CHANNEL ON THE SIDE RAILS TO AVOID END OF THE COVER BECOMING UNLATCHED.

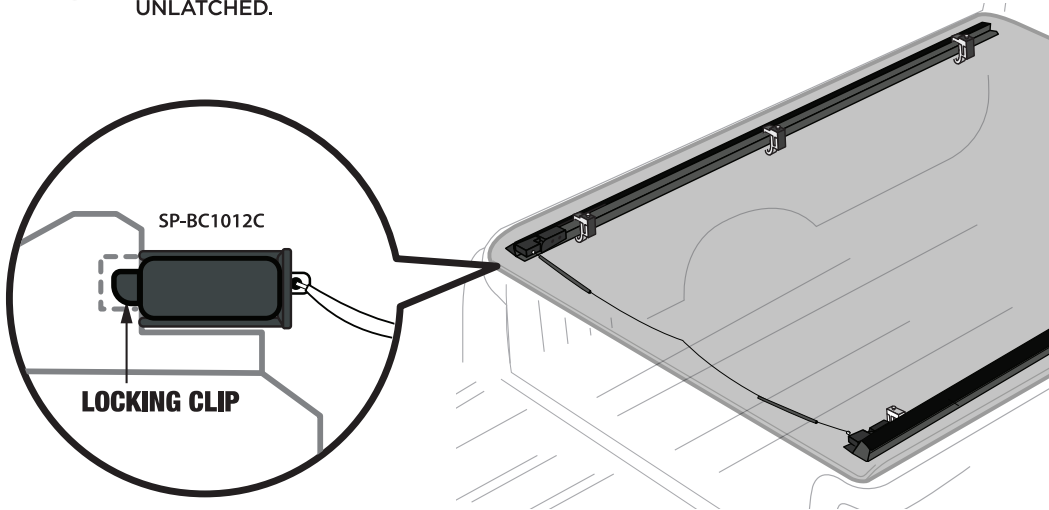

10

- IF COVER DOESN'T STAY CLOSED AND YOU FIND THE LOCKING CLIP IS NOT FULLY INSERTED.

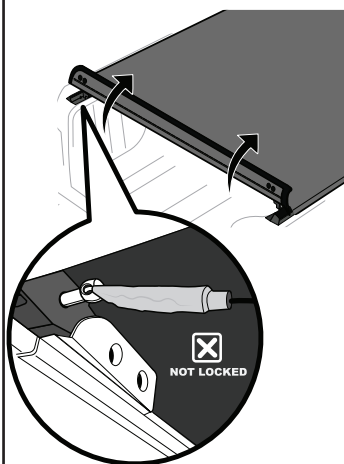

11

- TRY MOVING THE TENSION PLATE TOWARDS THE TAILGATE ON BOTH SIDES, ONE INCREMENT AT A TIME.

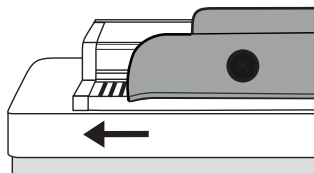

12

- MAKE SURE THE LOCKING CLIP ON BOTH SIDES ARE INSERTED INTO THE CHANNEL ON THE SIDE RAILS.

